



Marsh Wall, London, E14 9GS

Price:
£ 3,350 /pcm

Marsh Wall, London, E14 9GS

Price: £ 3,350 /pcm2 bedroom house

[View Property](#)

OVERVIEW

Stunning Fully Furnished Apartment in Harcourt Tower, South Quay – Canary Wharf.

Positioned within one of the UK's most prestigious new developments, this beautifully presented apartment offers contemporary living in the heart of London's business district. The open-plan living space features a premium Siemens-fitted kitchen with reconstituted stone worktops, sleek glass splashbacks, and handle-free cabinetry, while underfloor heating and comfort cooling ensure year-round comfort.

KEY FEATURES

- Available now
- Two bedroom apartment
- Furnished
- Comfort cooling & underfloor heating
- 56 floor bar and terrace
- Screening room & business lounges
- Residents lounge, gymnasium, pool, spa
- Excellently positioned for DLR and underground

Marsh Wall, E14

Approx Gross Internal Area = 55.5 sq m / 597 sq ft

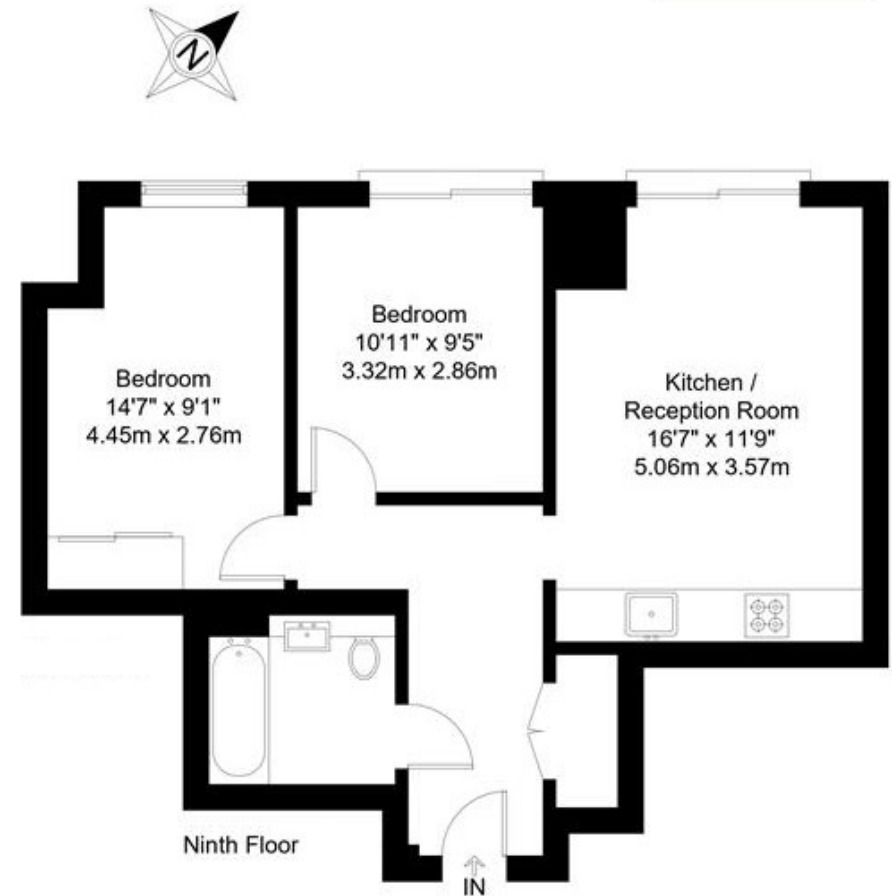

The Floor plan is not to scale and measurements and areas shown are approximate and therefore should be used for illustrative purposes only. The plan has been prepared in accordance with the RICS code of Measuring Practice and whilst we have confidence in the information produced it must not be relied on. Maximum lengths and widths are represented on the floor plan. If there is any aspect of particular importance, you should carry out or commission your own inspection of the property.

Copyright © BleuPlan

