

**Windlass House, 21 Schooner Road, E16 2PW**

Price:  
£ 400,000





# Windlass House, 21 Schooner Road, E16 2PW

Price: £ 400,000 1 bedroom house

[View Property](#)

## OVERVIEW

Available now is this luxurious one double bedroom apartment set within the recognised and sought after development, Windlass House, Royal Wharf, E16.

This fantastic property is situated on the second floor of E16's leading development, comprising of a spacious lounge/dining area with a modern kitchen featuring built in appliances, large double bedroom, modern bathroom and storage space throughout. Bright and spacious this home is complimented by a large private balcony overlooking the communal gardens.

## KEY FEATURES

- Large Private Balcony
- Overlooking Royal Wharf Gardens
- Spacious Double Bedroom
- Onsite Shops, Restaurants And Coffee Shops
- 24h Concierge Service And Security
- Residents Health Spa
- Gymnasium
- EWS1 Top A1 Rated
- Moments From Pontoon Dock DLR
- \*Available To View 7 Days A Week\*

# Windlass House

Royal Wharf, London, SE3  
Plot Area: 200 sq. ft. (23.2 sq. m)  
Built 2000

ERNEST-BROOKS  
INTERNATIONAL

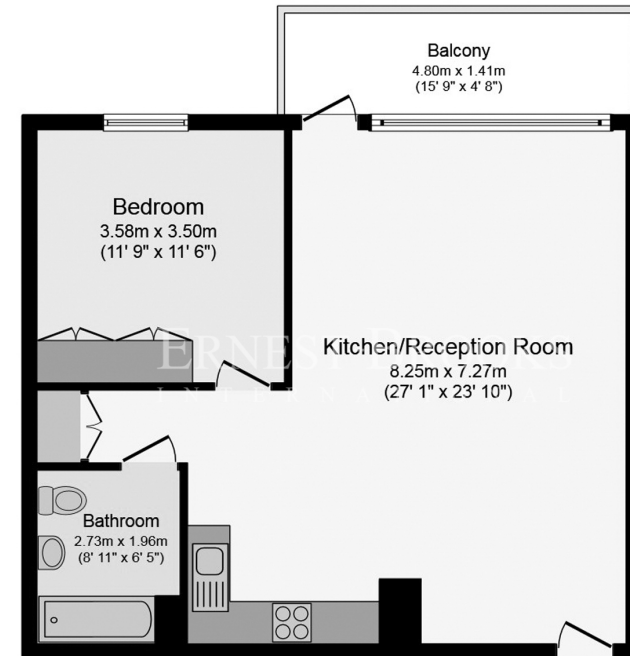

## Second Floor



Floor area 61.0 sq. m. (657 sq. ft.) approx

Whilst every attempt has been made to ensure the accuracy of the floor plan contained here, measurements of doors, windows, rooms and any other items are approximated and no responsibility is taken for any error, omission or mis-statement. This plan is for illustrative purposes only and should be used as such by prospective purchaser. The service, system and appliances shown have not been tested and no guarantee as to their operability or efficiency can be given.

Energy Performance Certificates



