



**Westmark Tower, 1 Newcastle Place, W2 1BW**

Price:

£ 5,220 /pcm





## Westmark Tower, 1 Newcastle Place, W2 1BW

Price: £ 5,220 /pcm2 bedroom house

[View Property](#)

### OVERVIEW

This beautiful FULLY FURNISHED two bedroom 19th floor apartment (949 Sq. Ft. with balcony) situated in The Westmark Tower of Berkeley Home's West End Gate development, W2

Westmark is the tallest of the buildings at West End Gate and provides dramatic views towards the City, Regent's Park and Hyde Park. A sense of arrival is created by a sweeping entrance with water features at ground level that transitions into a grand lobby with secluded seating areas providing residents with pockets of privacy.

### KEY FEATURES

- Available NOW!
- Furnished to a high standard
- Skyline views across London
- 949 Sq. Ft. + balcony
- Situated On The 19th Floor
- 24hr concierge, Swimming pool
- Spa & gym
- Cinema & Lounge
- Prime Location - Zone 1
- Walking Distance to Edgware Road Station
- Plethora of local shops & amenities

## Westmark Tower, W2

Approximate Gross Internal Area  
71.4 sq m / 769 sq ft

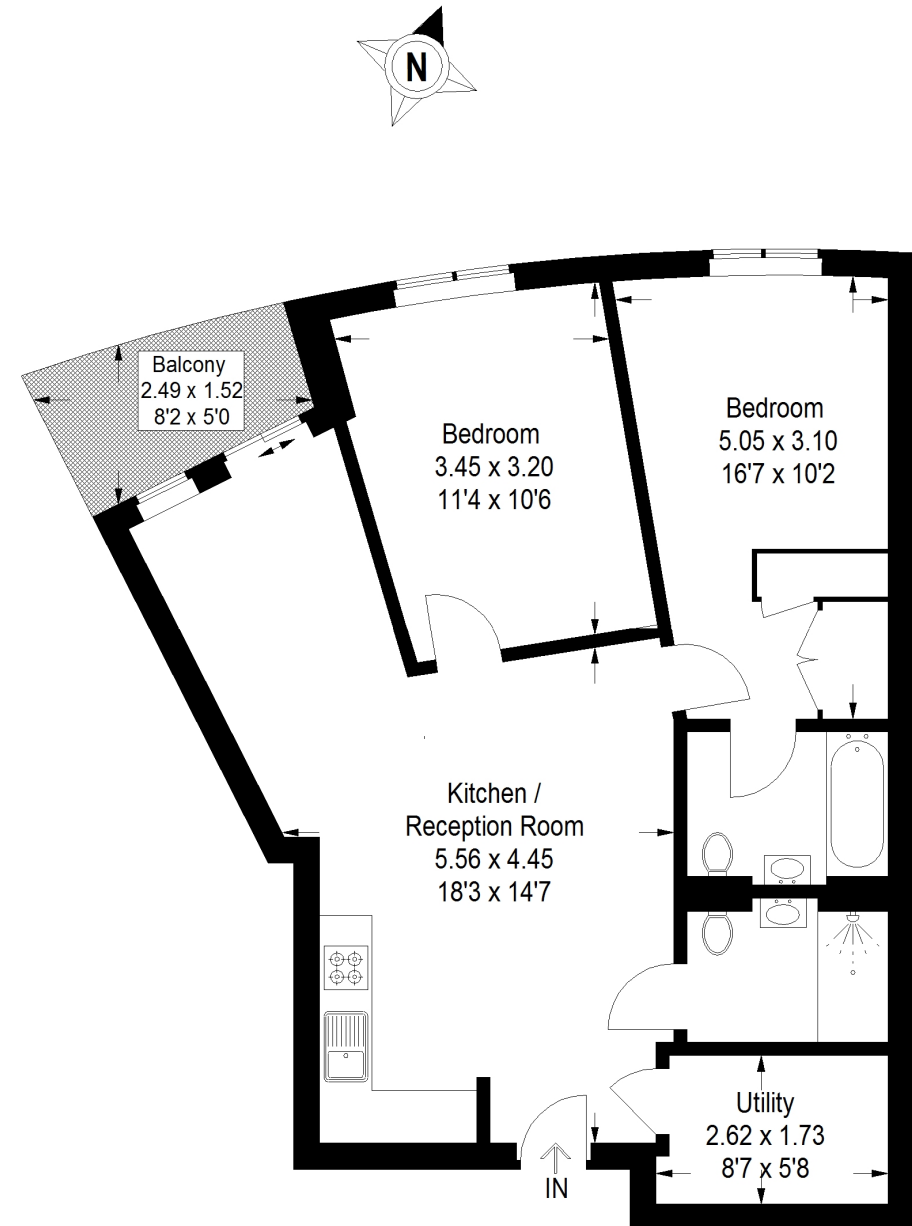

Nineteenth Floor



