



**Walkers Lodge, 579 Manchester Road, E14 3NT**

Price:  
£ 2,300 /pcm

# Walkers Lodge, 579 Manchester Road, E14 3NT

Price: £ 2,300 /pcm2 bedroom house

[View Property](#)

## OVERVIEW

Offered fully furnished is this modern two double bedroom split level apartment is well presented and comes full furnished. With an communal bathroom on bedroom level, the is also an additional guest WC, ample storage and communal garden space.

Situated between South Quay and Crossharbour DLR the flat is within close proximity to the wide choice of shops, cafés, restaurants and bars Canary Wharf has to offer.

## KEY FEATURES

- Two bedroom
- Furnished
- Duplex apartment
- Communal garden
- Ample storage
- Excellent transport links
- Moments from DLR Stations and Canary Wharf Station

# Walkers Lodge, E14

Approx Gross Internal Area = 70.4 sq m / 758 sq ft

EBI

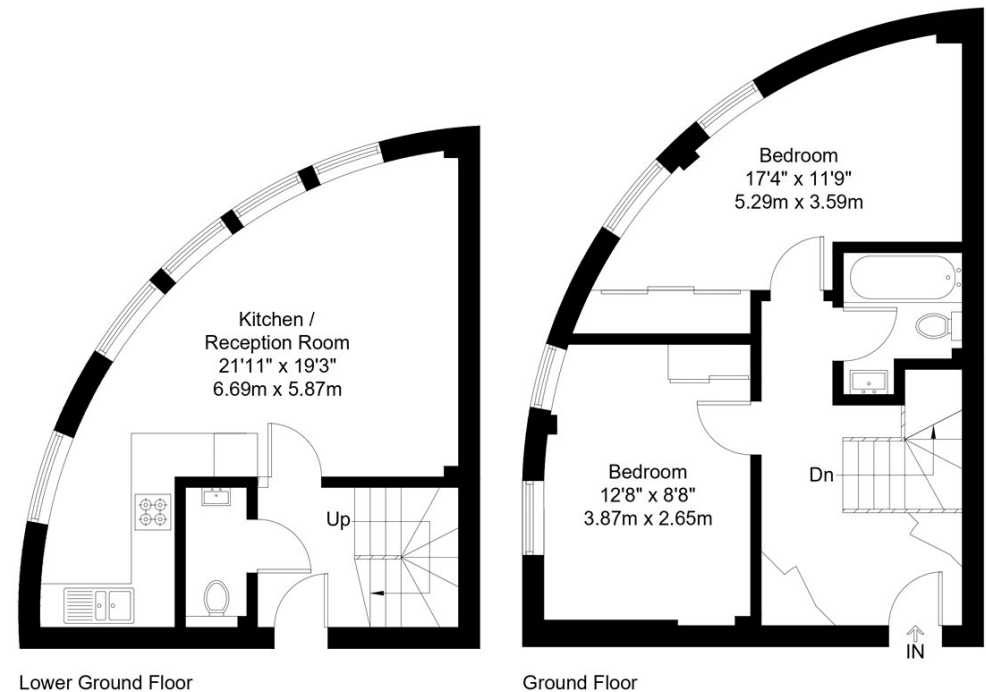

The Floor plan is not to scale and measurements and areas shown are approximate and therefore should be used for illustrative purposes only. The plan has been prepared in accordance with the RICS code of Measuring Practice and whilst we have confidence in the information produced it must not be relied on. Maximum lengths and widths are represented on the floor plan. If there is any aspect of particular importance, you should carry out or commission your own inspection of the property.

Copyright © BleuPlan



