

ERNEST BROS
INTERNATIONAL

Tivoli Court, Rotherhithe Street, SE16 5UD

Price:
£ 500,000

Tivoli Court, Rotherhithe Street, SE16 5UD

Price: £ 500,000 2 bedroom house

[View Property](#)

OVERVIEW

Stunning two bedroom river facing apartment located on the banks of The River Thames, on the fourth floor of the fantastic Tivoli Court.

Beautifully presented over 666sqft, the apartment is further complimented by two bright double bedrooms one which also offers a private balcony area, two stylish bathrooms and fully fitted kitchen.

KEY FEATURES

- Fourth floor
- Riverside development
- Two double bedrooms
- Private balcony
- Two bathrooms
- Stunning river views
- Resident Tennis Court
- Secure gated parking
- 666 sqft
- Quiet location with good transport links

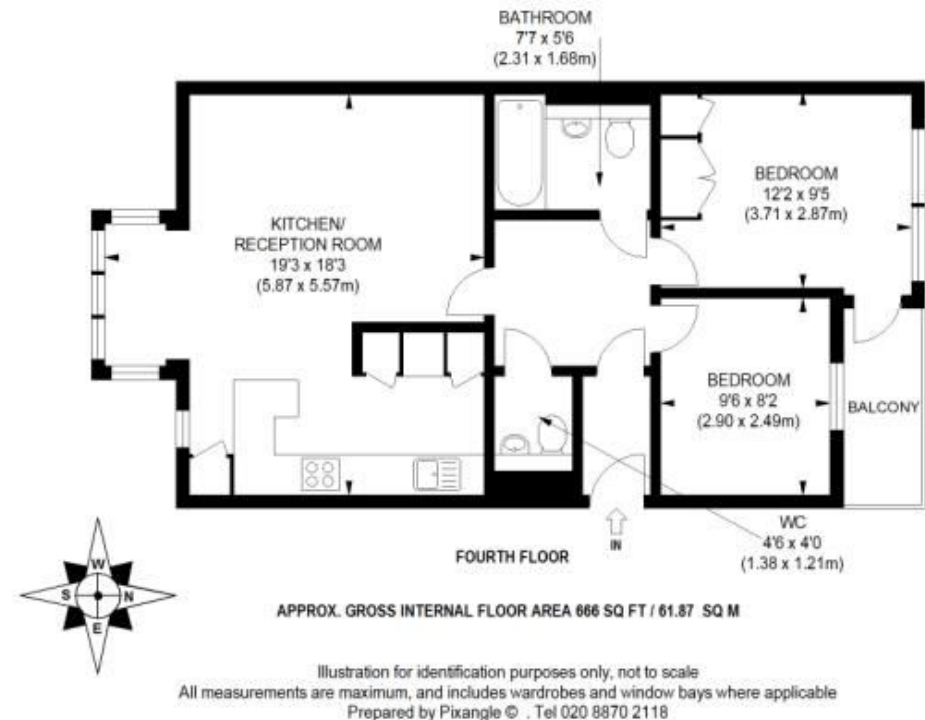

Energy Performance Certificates

