



**The Gallery, 38 Ludgate Hill, EC4M 7DE**

Price:

£ 525,000





# The Gallery, 38 Ludgate Hill, EC4M 7DE

Price: £ 525,000 1 bedroom house

[View Property](#)

## OVERVIEW

Set within the distinguished Grade II listed development of The Gallery at 38 Ludgate Hill, EC4, this exceptional top-floor one-bedroom apartment offers a rare opportunity to acquire a character residence in the very heart of the City of London. Spanning approximately 560 sq ft, the property blends historic architectural charm with modern urban living, positioned moments from the iconic St Paul's Cathedral.

The apartment features a well-proportioned layout with a bright open-plan living and kitchen area, thoughtfully designed to complement the building's historic structure while providing contemporary comfort. The top-floor position enhances privacy and natural light, creating a calm and elevated living environment above the energy of the City. The double bedroom is generously sized and served by a modern bathroom, offering a refined balance of heritage and functionality.

## KEY FEATURES

- Top floor one-bedroom apartment
- Approx. 560 sq ft internal space
- Grade II listed historic building
- Moments from St Paul's Cathedral
- Bright open-plan living space
- Well-proportioned double bedroom
- Modern fitted bathroom suite
- Excellent City of London location
- Close to City Thameslink Station
- Strong investment and rental appeal

# The Gallery EC4M

Approximate Gross Internal Area  
49.4 sq m / 532 sq ft



 = Reduced headroom below 1.5 m / 5'0

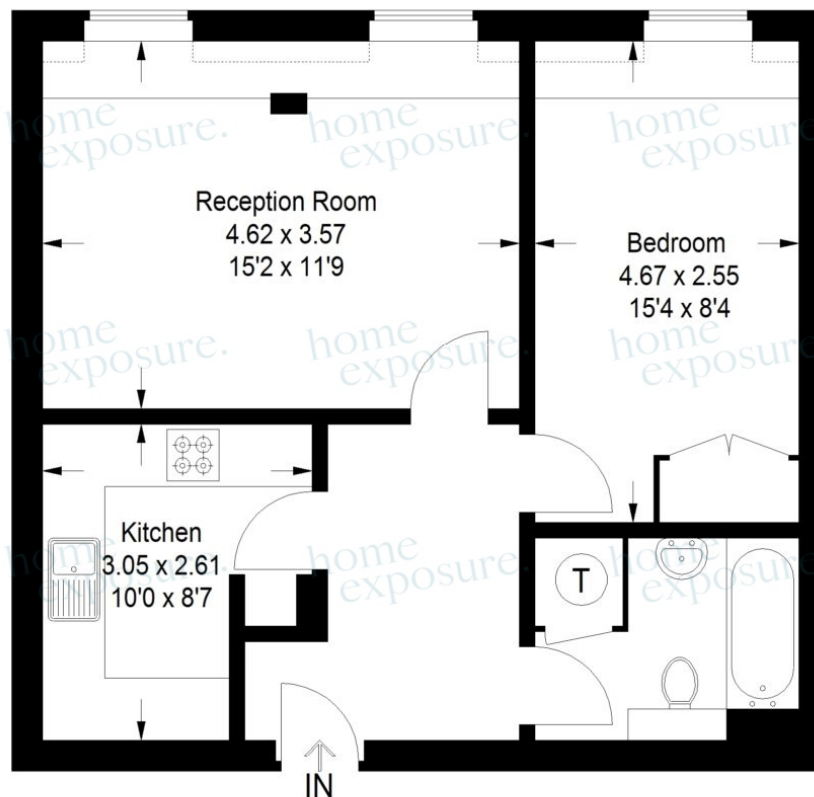

## Fifth Floor

This plan is for layout guidance only. Not drawn to scale unless stated. Windows and door openings are approximate. Whilst every care is taken in the preparation of this plan, please check all dimensions, shapes and compass bearings before making any decisions reliant upon them. (ID:900511)

