



**Stratosphere Tower, E15 1AZ**

Price:  
£ 800,000

# Stratosphere Tower, E15 1AZ

Price: £ 800,000 3 bedroom house

[View Property](#)

## OVERVIEW

Premium specification SUB PENTHOUSE Located on the 33rd floor this three bedroom apartment is spread over (1,034 Sq. Ft.) and further boasting a winter garden alongside dual aspect views from the top floors - East towards Canary Wharf, The O2, River Thames and South towards the City! Available in soon to be complete Stratosphere development, Stratford, E15.

Stratford station, including Tube, Overground, DLR and National Rail connections, is only a two-minute walk from the Stratosphere development. Stratosphere will set a new level of luxury for the Stratford area with facilities such as 24 hour concierge services, private residents' roof-top garden, Wi-Fi lounge, gymnasium and underfloor heating throughout.

## KEY FEATURES

- Sub Penthouse High Floor Views! 1,034 sqft - Level 33rd 24 Hour Concierge Services Wi-Fi Lounge & Gymnasium Private Residents' roof-top garden 10 Year NHBC Warranty Tenure: Leasehold 999 years Estimated Service Charge: £3.50 psf per Ground Rent: £450 per Completion due Q1 2018

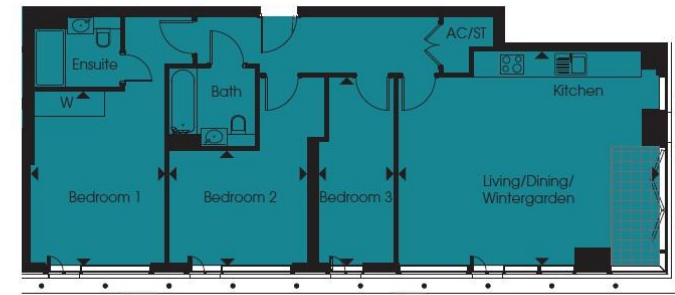

View towards Canary Wharf, The City & Queen Elizabeth Olympic Park

View towards The O2, The River Thames & Canary Wharf

APARTMENT	
Kitchen/Living/Dining/Wintergarden	6.65m x 5.47m 21'10" x 17'11"
Bedroom 1	4.45m x 3.44m 14'7" x 11'3"
Bedroom 2	3.53m x 2.94m 11'7" x 9'8"
Bedroom 3	4.80m x 1.94m 15'9" x 6'4"
<b>Total Area</b>	<b>96.1 sq m 1,034 sq ft</b>



