

ERNEST-BROOKS
INTERNATIONAL

Stratosphere Tower, E15 1AZ

Price:
£ 425,000

Stratosphere Tower, E15 1AZ

Price: £ 425,000 1 bedroom house

[View Property](#)

OVERVIEW

HIGH FLOOR CITY VIEWS! Large 23rd floor west facing one bedroom apartment, spread over (567 Sq. Ft.) with a winter garden offering far reaching views over The City & Olympic park. Completing soon in the brand new Stratosphere Tower. Photos show the actual apartment & view for sale!

Stratford station, including Tube, Overground, DLR and National Rail connections, is only a two-minute walk from the Stratosphere development. Stratosphere will set a new level of luxury for the Stratford area with facilities such as 24 hour concierge services, private residents' roof-top garden, Wi-Fi lounge, gymnasium and underfloor heating throughout.

KEY FEATURES

- TWENTY THIRD FLOOR! 571 sqft West Facing Towards The City, Olympic Park & Stratford City 24 Hour Concierge Services Wi-Fi Lounge & Gymnasium Private Residents' roof-top garden 10 Year NHBC Warranty Tenure: Leasehold 999 Years Estimated Service Charge: £33.50 per sq ft Ground Rent: £3350 per annum Completion due Feb 2018

FLOOR TWENTY THREE

APARTMENT

Kitchen/Living/Dining/Wintergarden
8.77m x 3.35m 28'9" x 11'0"

Bedroom
3.94m x 2.90m 12'11" x 9'6"

Total Area
52.7 sq m 567 sq ft

View towards The City,
Queen Elizabeth
Olympic Park &
Westfield Stratford City

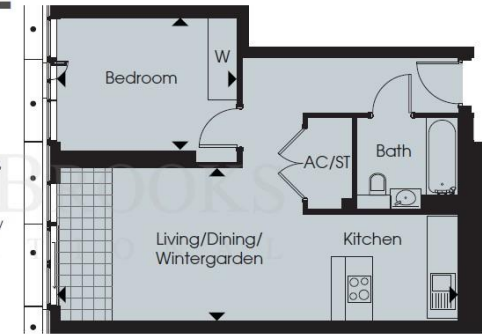

View towards Canary Wharf, The City
& Queen Elizabeth Olympic Park

