



Stratosphe Tower, 55 Great Eastern Road, E15 1DU

Price:
£ 469,000

Stratosphere Tower, 55 Great Eastern Road, E15 1DU

Price: £ 469,000 1 bedroom house

[View Property](#)

OVERVIEW

RARE FIND This large 28th floor west facing one bedroom apartment, spread over (627 Sq. Ft.) with a winter garden facing towards The City & Olympic park.

Stratford station, including Tube, Overground, DLR and National Rail connections, is only a two-minute walk from the Stratosphere development. Stratosphere will set a new level of luxury for the Stratford area with facilities such as 24 hour concierge services, private residents' roof-top garden, Wi-Fi lounge, gymnasium and underfloor heating throughout.

KEY FEATURES

- 28th floor
- West facing towards Olympic Park
- 24 Hour concierge services
- Wi-Fi Lounge & gymnasium
- Private residents' roof-top garden
- 10 Year NHBC Warranty
- Tenure: Leasehold 999 Years
- Estimated Service charge: £33.50 psf pa
- Ground rent: £3350 pa

FLOOR TWENTY EIGHT

Kitchen/Living/Dining/Wintergarden	
8.77m x 3.57m	28'9" x 11'9"
Bedroom	
5.19m x 2.95m	17'0" x 9'8"
Total Area	
58.2 sq m	627 sq ft

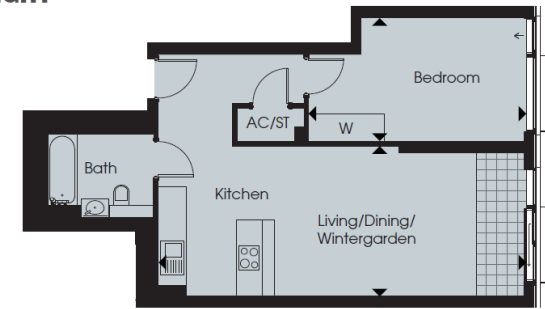

View towards The O2,
The River Thames
& Canary Wharf

View towards Canary Wharf, The City
& Queen Elizabeth Olympic Park



