



Stratosphere, E15 1AZ

Price:
£ 425,000

Stratosphere, E15 1AZ

Price: £ 425,000 1 bedroom house

[View Property](#)

OVERVIEW

Priced To Sell This 13th floor one bed apartment spread over (565 Sq. Ft) with a winter garden facing favored West - views towards The City, Queen Elizabeth Olympic Park. Available now in Stratosphere, Stratford, E15.

Stratford station, including Tube, Overground, DLR and National Rail connections, is only a two-minute walk from the Stratosphere development. Stratosphere will set a new level of luxury for the Stratford area with facilities such as 24 hour concierge services, private residents' roof-top garden, Wi-Fi lounge, gymnasium and underfloor heating throughout.

KEY FEATURES

- 13th Floo - West Aspect
24 hou conciege sevice
Wi-Fi lounge & gymnasium
Private Residents' Roof-Top Gaden
10 Yea NHBC WaantyEst
Sevice chage: u00a333.50 psf
Tenue: Leasehold 999 yeas
Est Gound ent: u00a3350 pa
Completion due Winte 2017

FLOOR THIRTEEN

APARTMENT

Kitchen/Living/Dining/Wintergarden
8.77m x 3.32m 28'9" x 10'11"

Bedroom
3.94m x 2.87m 12'11" x 9'5"

Total Area
52.5 sq m 565 sq ft

View towards The City,
Queen Elizabeth
Olympic Park &
Westfield Stratford City

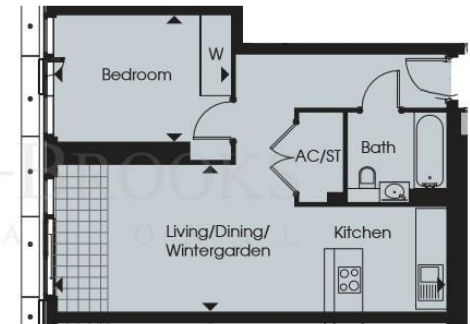

View towards Canary Wharf, The City
& Queen Elizabeth Olympic Park

