



Sky Apartments, Homerton Road, E9 5FA

Price:

£ 499,950

Sky Apartments, Homerton Road, E9 5FA

Price: £ 499,950 2 bedroom house

[View Property](#)

OVERVIEW

Well priced & vacant! This two Bedroom (766sq ft) 10th floor apartment with parking and a private balcony with river views in Sky Apartments, Hackney Wick, E9. This apartment comprises a generously spacious open plan lounge & kitchen space with access to the expansive views enjoyable from the river facing balcony as well as good specification kitchen space including inbuilt appliances. There is a family bathroom as well as two double bedrooms, the master with en suite facilities and built in wardrobe space. There is plenty of alternative storage space available in the apartment.

This spacious 10th floor apartment is finished to the highest standard, offering stylish comfortable living. Features include under floor heating, wood flooring, tiled bathrooms and stone worktops. Views overlooking the River Lea. The Apartment also has access to a communal roof terrace, with views of the Olympic Village. Residents of Sky Apartments enjoy amenities such as a private residents gym and 24 hour concierge service.

KEY FEATURES

- Two Bedroom Apartment 10th Floor - Views of River Lea, Olympic Park & London Stadium
Allocated Parking Space
Residents Gymnasium
24hr Concierge Service
EPC: Br
Lease Term: 999Yrs
Service Charge: £3,300 (approximate)
Ground Rent: £250 PA
Developer: Telford Homes

Sky Apartments

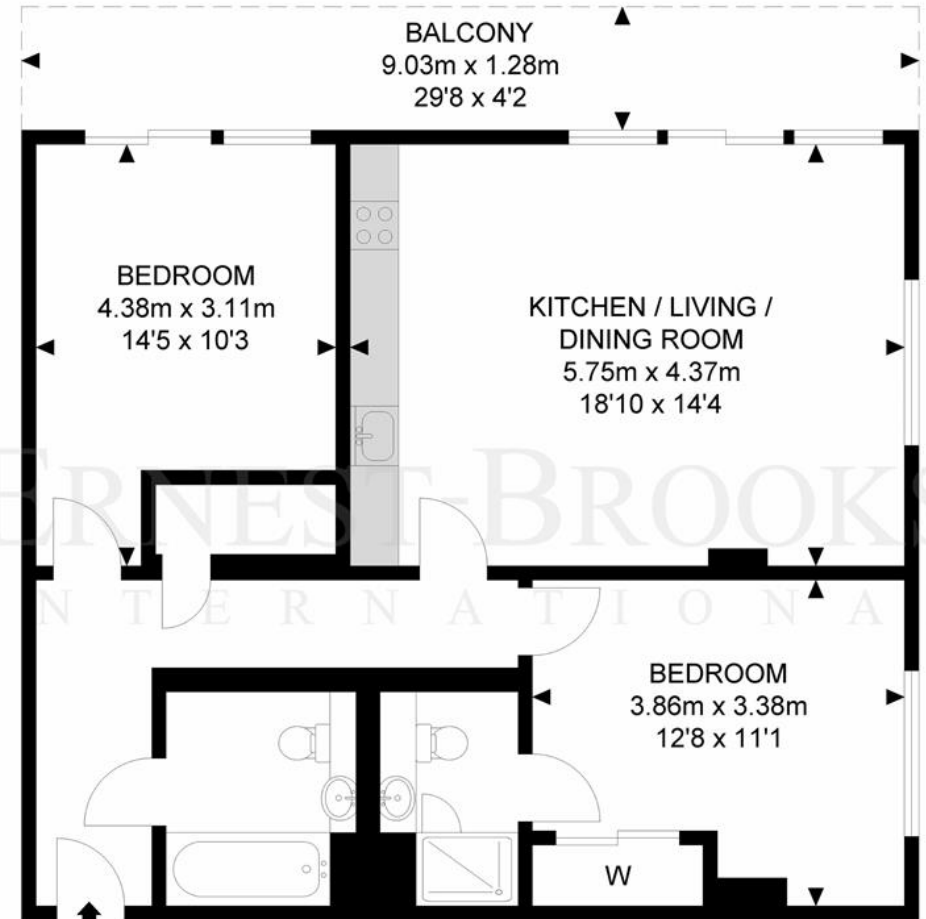

Tenth Floor

APPROX. GROSS INTERNAL FLOOR AREA 766.39 SQ FT / 71.20 SQM

Whilst every attempt has been made to ensure the accuracy of the floor plan contained here, measurements of doors, windows, rooms and any other items are approximate and no responsibility is taken for any error, omission or mis-statement. This plan is for illustrative purposes only and should be used as such by any prospective purchaser. The service, system and appliances shown have not been tested and no guarantee as to their operability or efficiency can be given.

© SpacePhoto

Photography and Floor Plan

