



Sienna Alto, 2 Cornmill Lane, SE13 7FZ

Price:
£ 480,000

Sienna Alto, 2 Cornmill Lane, SE13 7FZ

Price: £ 480,000 2 bedroom house

[View Property](#)

OVERVIEW

A well-positioned two bedroom, two bathroom apartment (764 sqft) plus a huge (268 sqft) balcony wrapping around the perimeter of the apartment offering show stopping views from the 20th floor moments from Lewisham station.

Large well-presented apartment situated on the 20th floor offering open plan kitchen/living area flooded with natural light. The kitchen offers white gloss unit doors, integrated appliances, recessed lighting under wall units and ample amounts of storage. The living space enjoys floor-to-ceiling glazing with access onto the large wrap-around outdoor balcony.

KEY FEATURES

- Two bedroom, two bathroom
- Large wrap-around balcony
- 20th floor Canary Wharf views
- Chain free
- 24 hour concierge service
- Residents' outdoor garden
- DLR and National Rail
- Service charge: £31,850pa
- Ground rent: £3350pa
- Leasehold: TBC

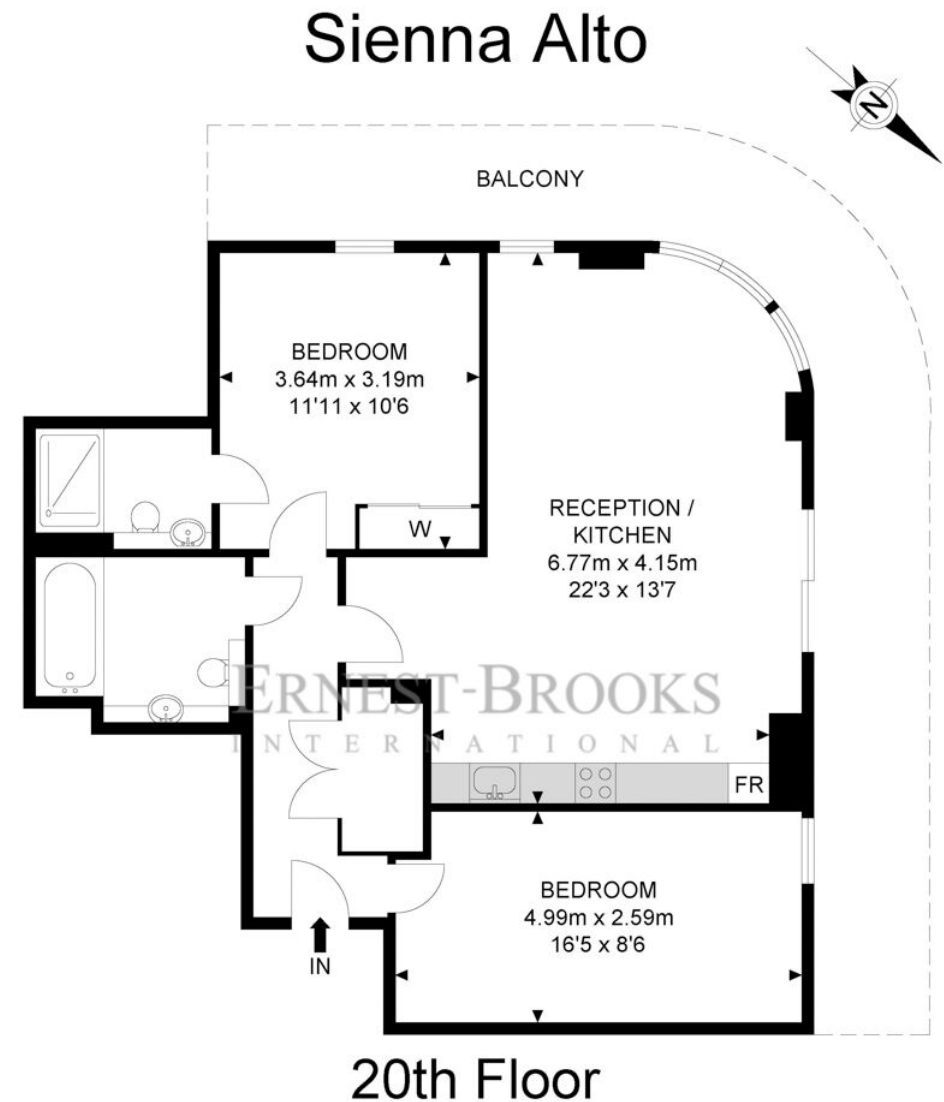

APPROX. GROSS INTERNAL FLOOR AREA 764.23 SQ FT / 71.0 SQM
APPROX. GROSS EXTERNAL FLOOR AREA 268.02 SQ FT / 24.90 SQM

Whilst every attempt has been made to ensure the accuracy of the floor plan contained here, measurements of doors, windows, rooms and any other items are approximated and no responsibility is taken for any error, omission or mis-statement. This plan is for illustrative purposes only and should be used as such by any prospective purchaser. The service, system and appliances shown have not been tested and no guarantee as to their operability or efficiency can be given.

© SpacePhoto

Photography and Floor Plan

Energy Performance Certificates

