

The EBI logo is located in the top right corner of the image. It consists of the letters 'EBI' in a white, serif font, centered within a dark blue square. The square has thin white horizontal lines above and below the text.

EBI

A large, semi-transparent 'EBI' watermark is centered over the kitchen area of the image. It is rendered in a blue, serif font with horizontal lines above and below the letters.

EBI

**School Road, Hastings, TN35 5AZ**

Price:  
£ 1,700 /pcm





# School Road, Hastings, TN35 5AZ

Price: £ 1,700 /pcm3 bedroom house

[View Property](#)

## OVERVIEW

**\*OPEN DAY THIS SATURDAY 8th FEB\*\*** Rare-to-market, this brand new large three double-bedroom house offers two bathrooms and underfloor heating. Luxurious and stylish throughout, it has been finished to an exceptionally high standard and comes fully furnished with a premium furniture pack. Developed by a high-quality developer known for their exceptional properties, tenants rarely leave once they move in.

The property boasts bright and spacious accommodation, featuring an entrance hallway and a living room with a front-facing window. The newly fitted open-plan kitchen is equipped with integrated Hotpoint appliances, including an oven, hob, dishwasher, and a tall fridge-freezer. The bathrooms are equipped with underfloor heating; the downstairs bathroom includes a shower over the bath, while the first-floor bathroom showcases a modern design with a walk-in dual shower, underfloor heating, an LED backlit mirror, and contemporary flush appliances.

## KEY FEATURES

- Fully furnished with a premium furniture pack
- Rare-to-market, fully renovated
- Three double-bedroom house
- Luxurious, underfloor-heated bathroom
- Finished to an exceptionally high standard
- Stylish and contemporary living space
- Bright, spacious open-plan kitchen with integrated Hotpoint appliances
- Large third bedroom spanning the entire second floor, featuring a Velux skylight
- Utility room with washing machine & dryer
- LED lighting throughout, enhancing the modern aesthetic
- On-road parking available
- Viewings by appointment - act quickly!

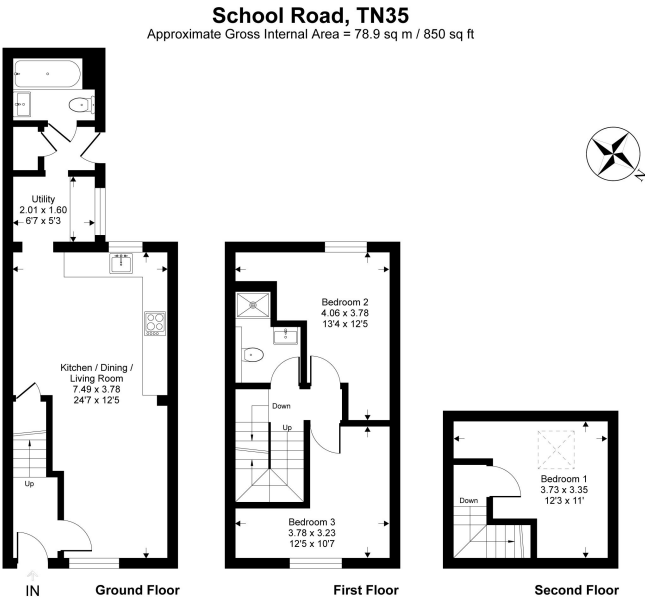

This floor plan is for representation purposes only as defined by the RICS code of Measuring Practice (and IPMS where requested) and should be used as such by any prospective purchaser. Whilst every attempt has been made to ensure the accuracy contained here, the measurement of doors, windows and rooms is approximate and no responsibility is taken for any error, omission or mis-statement. Specifically no guarantee is given on the total area of the property if quoted on the plan. Any figure provided is for guidance only and should not be used for valuation purposes.

Copyright Casaphoto Ltd. 2025 - Produced for Ernest Brooks

## Energy Performance Certificates

