



**Sail Loft Court, 10 Clyde Square, E14 7TA**

Price:

£ 460,000





# Sail Loft Court, 10 Clyde Square, E14 7TA

Price: £ 460,000 1 bedroom house

[View Property](#)

## OVERVIEW

RARE TRIPLE HEIGHT PENTHOUSE! Light and airy well presented apartment, boasting 3 height feature windows from the reception and bedroom. Spread over a generous (583 Sq. Ft) and located in the popular building Sail Loft Court, a canal-side development in Limehouse, E14.

The neighbour penthouse the same layout has added a mezzanine bedroom level for £15,000 and its value is now £550,000.

## KEY FEATURES

- 583 sq. ft. northwest-facing apartment
- Rare feature windows for enhanced natural light
- Sought-after canal-side development
- Residents' concierge services for convenience
- Ground rent: 3300 per annum
- Long lease: 991 years
- Service charge: 34,300 per annum
- Viewings available!

# Sail Loft Court

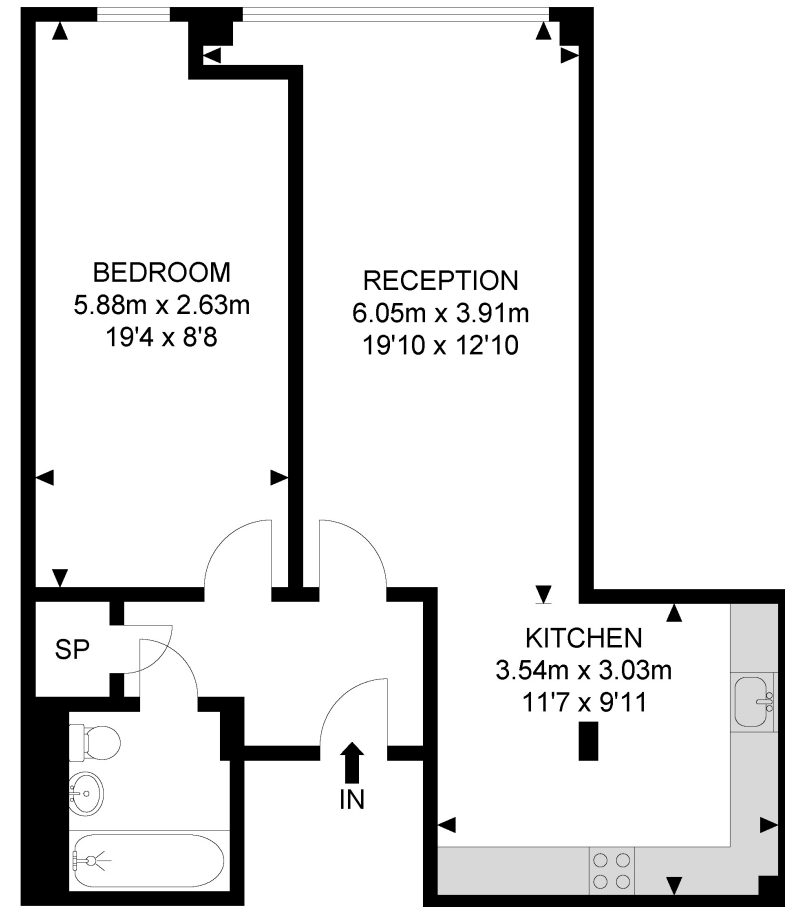

1st Floor

APPROX. GROSS INTERNAL FLOOR AREA 582.32 SQ FT / 54.1 SQM

measurements of doors, windows, rooms and any other items are approximates and no responsibility is taken for any error, omission or mis-statement. this plan is for illustrative purposes only and should be used as such by any prospective purchaser. the service, system and appliances shown have not been tested and no guarantee as to their operability or efficiency can be given.

© SpacePhoto

Photography and Floor Plan

Energy Performance Certificates



