



**Sail Loft Court, 10 Clyde Square, E14 7TA**

Price:

£ 1,880 /pcm





# Sail Loft Court, 10 Clyde Square, E14 7TA

Price: £ 1,880 /pcm1 bedroom house

[View Property](#)

## OVERVIEW

This light and airy, PENTHOUSE flat offering triple height ceilings, located in a warehouse conversion!! Well presented apartment, boasting feature windows from the reception & bedroom. Spread over a generous (583 Sq. Ft) and located in the popular building Sail Loft Court, a canal-side development in Limehouse, E14.

The apartment comprises a spacious reception area with heightened ceilings and a modern kitchen space with integrated Neff appliances. There is a modern bathroom suite and double bedroom with built in wardrobe storage. The apartment is installed with the latest technology such as thermostatically controlled heating, recessed down lighting, an electronic video entry phone system, Satellite TV, Radio and a telephone system.

## KEY FEATURES

- Penthouse
- Triple height ceilings
- Fully furnished
- Large 583 sqft
- Noth West facing
- Rare Feature Windows
- Canal Side Development
- Residents Concierge Services
- Viewings Welcome

## Sail Loft Court

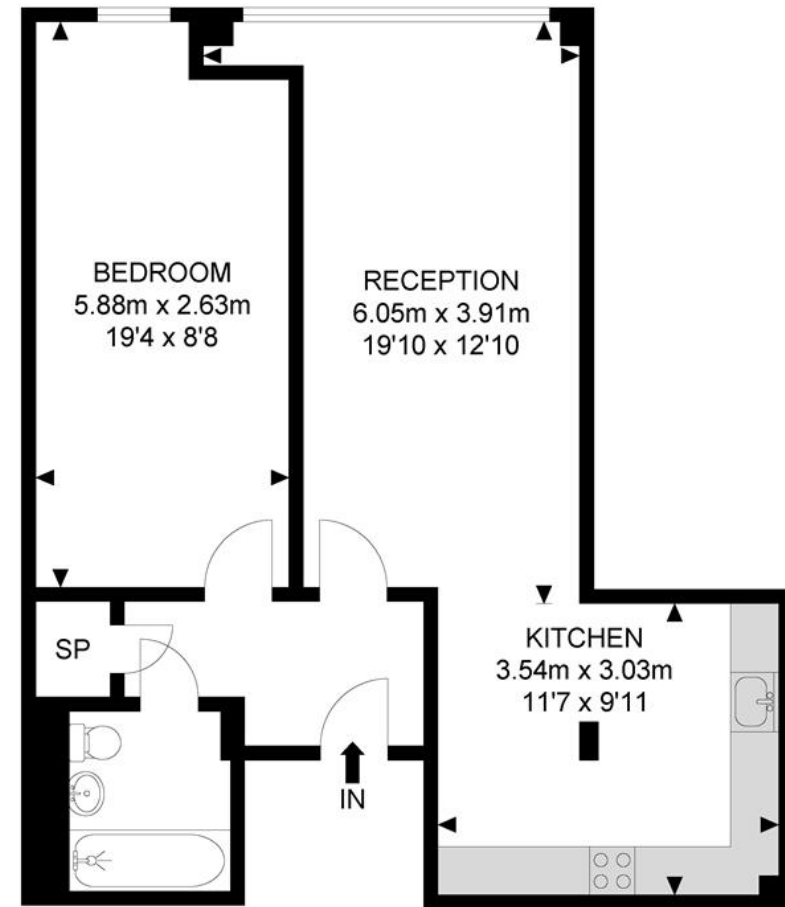

1st Floor

APPROX. GROSS INTERNAL FLOOR AREA 582.32 SQ FT / 54.1 SQM

measurements of doors, windows, rooms and any other items are approximates and no responsibility is taken for any error, omission or mis-statement. this plan is for illustrative purposes only and should be used as such by any prospective purchaser. the service, system and appliances shown have not been tested and no guarantee as to their operability or efficiency can be given.

© SpacePhoto

Photography and Floor Plan

Energy Performance Certificates



