



**Rosewood Building, Shoreditch Exchange, Gorsuch Place, E2 8HU**

Price:  
£ 3,100 /pcm

## Rosewood Building, Shoreditch Exchange, Gorsuch Place, E2 8HU

Price: £ 3,100 /pcm2 bedroom house

[View Property](#)

### OVERVIEW

A beautifully presented large two bedroom apartment located within the highly sought-after Shoreditch Exchange development. Offering contemporary living, the property features a bright open-plan reception area leading onto a spacious private balcony, two double bedrooms, and high-spec finishes throughout.

Residents benefit from a range of on-site amenities including a 24-hour concierge service, fully equipped gym, private cinema room, club lounge, and beautifully landscaped roof terraces and courtyards.

### KEY FEATURES

- Spacious private balcony
- 24-hour concierge service
- Residents' gym, cinema room and lounge
- Landscaped courtyard and roof terrace
- Moments from Hoxton and Old Street Stations
- Easy access to Liverpool Street and Crossrail
- Vibrant Shoreditch location near tech hubs and nightlife

## Gorsuch Place, E2

Approx Gross Internal Area = 63.9 sq m / 688 sq ft

Balcony = 6.6 sq m / 71 sq ft

Total = 70.5 sq m / 759 sq ft

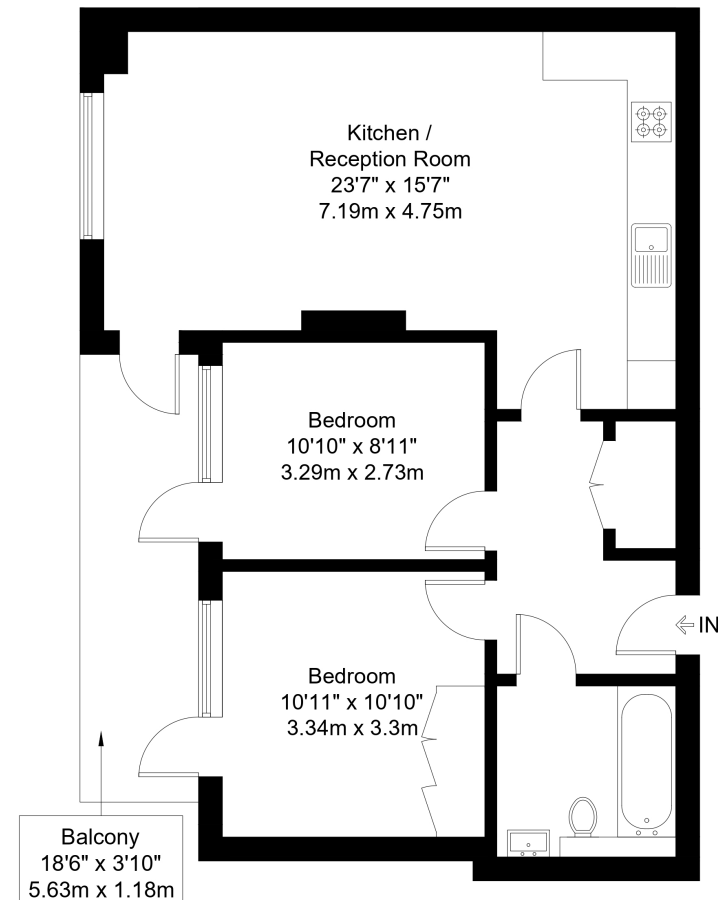

Fourth Floor

The Floor plan is not to scale and measurements and areas shown are approximate and therefore should be used for illustrative purposes only. The plan has been prepared in accordance with the RICS code of Measuring Practice and whilst we have confidence in the information produced it must not be relied on. Maximum lengths and widths are represented on the floor plan. If there is any aspect of particular importance, you should carry out or commission your own inspection of the property.  
Copyright © BleuPlan



