



Richard Neale House, Cornwall Street, E1 2QW

Price:
£ 550,000

Richard Neale House, Cornwall Street, E1 2QW

Price: £ 550,000 5 bedroom house

[View Property](#)

OVERVIEW

With the propensity of a 7% rental yield, this once two separate flats has been joined into one and now holds five double individual bedrooms.

The property itself is situated on the third floor of a well maintained purpose built block and offers nearly 1200 Sq. Ft of internal living space. Richard Neale House also offers two private, south facing balcony spaces and two bathrooms, with two additional W/Cs which make it perfect for sharers throughout. There is also a kitchen space and generously sized reception room which could be converted into a further bedroom space.

KEY FEATURES

- *6% Rental Yield*
- Supeb buy-to-let investment
- Five bedoom popety
- Two bathooms and two W/Cs
- Two private balconies
- Situated on the thid floo
- Compiled at nealy 1200 Sq. Ft
- 0.1 Miles fom Shadwell DLR Station
- Lift to block
- Pefect fo shaes

Richard Neale House

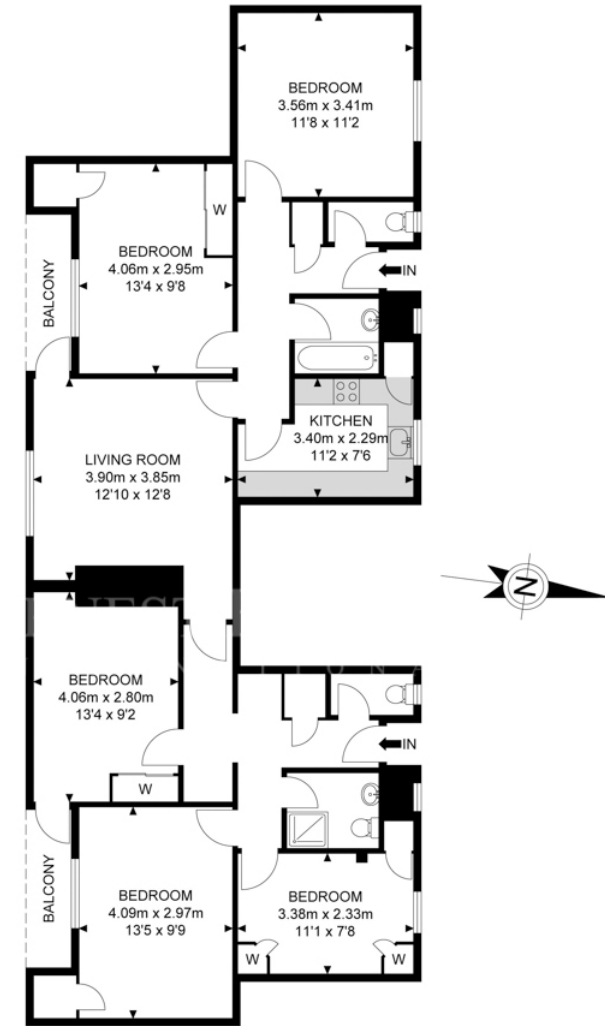

3rd Floor



APPROX. GROSS INTERNAL FLOOR AREA 1174.34 SQ FT / 109.10 SQM
APPROX. GROSS EXTERNAL FLOOR AREA 58.12 SQ FT / 5.40 SQM

Whilst every attempt has been made to ensure the accuracy of the floor plan contained here, measurements of doors, windows, rooms and any other items are approximated and no responsibility is taken for any error, omission or mis-statement. This plan is for illustrative purposes only and should be used as such by any prospective purchaser. The service, system and appliances shown have not been tested and no guarantee as to their operability or efficiency can be given.

© SpacePhoto

Photography and Floor Plan

Energy Performance Certificates

