



Rectangular Tower, City North, N4 3HF

Price:
£ 450,000

Rectangular Tower, City North, N4 3HF

Price: £ 450,000 1 bedroom house

[View Property](#)

OVERVIEW

Well placed 13th floor apartment! Enjoy skyline views of Canary Wharf, Finsbury Park & The City from this 13th floor apartment. Boasting 517 sqft plus large private balcony with high quality interiors such as underfloor heating, high gloss Urban Myth kitchen and integrated appliances.

Located adjacent to the 110-acre Finsbury Park, City North can be regarded as the perfect blend between residential and commercial spaces. City North provides residents with a host of amenities such as; 24hr concierge & security, residents lounge as well as beautifully landscaped communal gardens. Additionally there will be on-site premium retail space including shops, restaurants, cinemas and a state-of-the-art gym.

KEY FEATURES

- Located On The 13th Floor
- Skyline view of Canay Whaf & The City
- 517 sq ft Plus Lage Balcony
- 24 Hou Conciege & Secuity
- Seconds Fom Finsbuy Pak Station
- Tenue: 999 Yeas Leasehold
- Est Gound Rent: u00a3400 pa
- Est Completion: Sping 2020
- Est Sevice Chage: u00a333.75 psf pa
- NOT ON HELP TO BUY

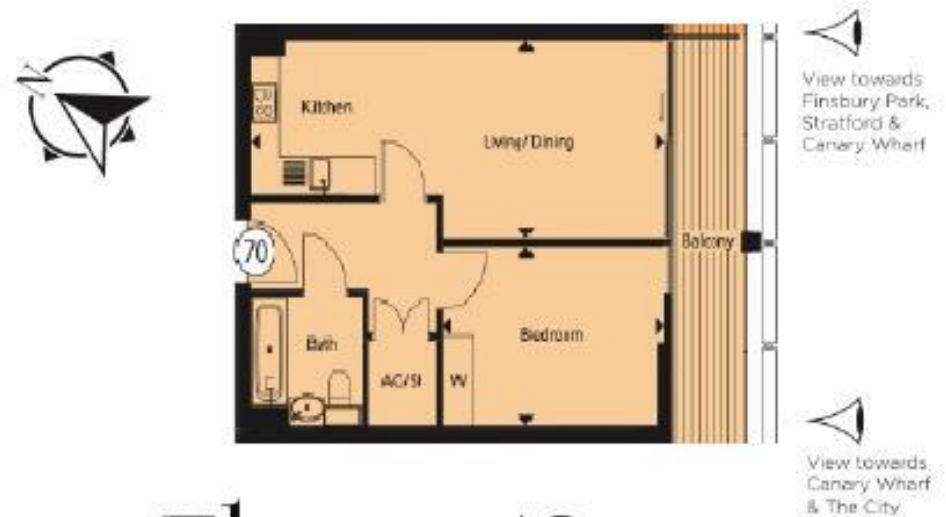

Floor 13

Kitchen/Living/Dining	8.11m x 3.07m	26'7" x 10'1"
Bedroom	4.32m x 2.77m	14'2" x 9'1"
Total Area	48 sq m	517 sq ft

