



Park View Mansions, Olympic Park View Avenue, E20 1FA

Price:

£ 475,000

Park View Mansions, Olympic Park View Avenue, E20 1FA

Price: £ 475,000 1 bedroom house

[View Property](#)

OVERVIEW

Set within the highly desirable Park View Mansions on Olympic Park View Avenue, E20, this elegant one-bedroom fourth-floor apartment offers contemporary living with direct views over the world-renowned Queen Elizabeth Olympic Park. Spanning approximately 590 sq ft, the property combines generous proportions, modern interiors, and a rare park-facing aspect, making it an outstanding opportunity for professionals, first-time buyers, and investors alike.

The apartment features a bright and well-designed open-plan living and kitchen space, enhanced by floor-to-ceiling glazing that maximises natural light and frames uninterrupted views of the Olympic Park. The private balcony provides a peaceful outdoor retreat, perfectly positioned to enjoy the green surroundings and iconic waterways of Stratford's most celebrated parkland. The double bedroom is well-proportioned and complemented by a sleek, contemporary bathroom, offering both comfort and functionality.

KEY FEATURES

- Fourth floor one-bedroom apartment
- Approx. 590 sq ft internal space
- Private balcony with park views
- Direct Queen Elizabeth Olympic Park outlook
- Bright open-plan living area
- Modern contemporary bathroom
- Excellent Stratford transport links
- Elizabeth Line and Jubilee access
- Close to Westfield Stratford City
- Strong rental and investment demand

Park View Mansions, E20

Approx Gross Internal Area = 50 sq m / 538 sq ft

Balcony = 4.8 sq m / 52 sq ft

Total = 54.8 sq m / 590 sq ft

EBI

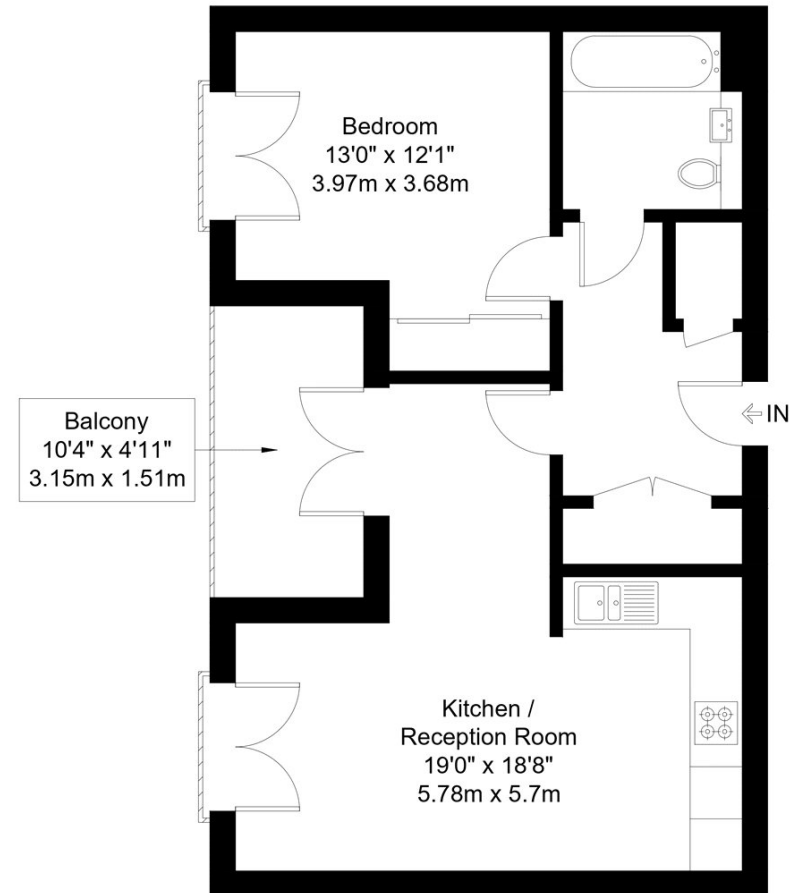

Fourth Floor

The Floor plan is not to scale and measurements and areas shown are approximate and therefore should be used for illustrative purposes only. The plan has been prepared in accordance with the RICS code of Measuring Practice and whilst we have confidence in the information produced it must not be relied on. Maximum lengths and widths are represented on the floor plan. If there is any aspect of particular importance, you should carry out or commission your own inspection of the property.

Copyright @ BleuPlan

Energy Performance Certificates

