



**Park View Mansions, Olympic Park View Avenue, E20 1FA**

Price:  
£ 500,000





# Park View Mansions, Olympic Park View Avenue, E20 1FA

Price: £ 500,000 1 bedroom house

[View Property](#)

## OVERVIEW

Situated on the fourth floor of the highly sought-after Park View Mansions, this impressive one-bedroom apartment spans approximately 590 sq ft and enjoys exceptional, uninterrupted views across the Queen Elizabeth Olympic Park.

The apartment offers a bright, well-balanced layout, centred around a spacious open-plan reception and kitchen area designed to maximise natural light and outlook. Floor-to-ceiling windows beautifully frame the expansive park views, creating a rare sense of openness and privacy seldom found within E20.

## KEY FEATURES

- Fourth floor one bedroom apartment in Park View Mansions
- Approximately 590 sq ft of well proportioned living space
- Exceptional unobstructed views across Olympic Park
- Bright open plan reception with large picture windows
- Modern fully integrated kitchen with sleek finish
- Spacious double bedroom with built in storage
- Contemporary bathroom finished to high standard
- Moments from Stratford Station and Westfield Stratford City

# Park View Mansions, E20

Approx Gross Internal Area = 50 sq m / 538 sq ft

Balcony = 4.8 sq m / 52 sq ft

Total = 54.8 sq m / 590 sq ft

# EBI

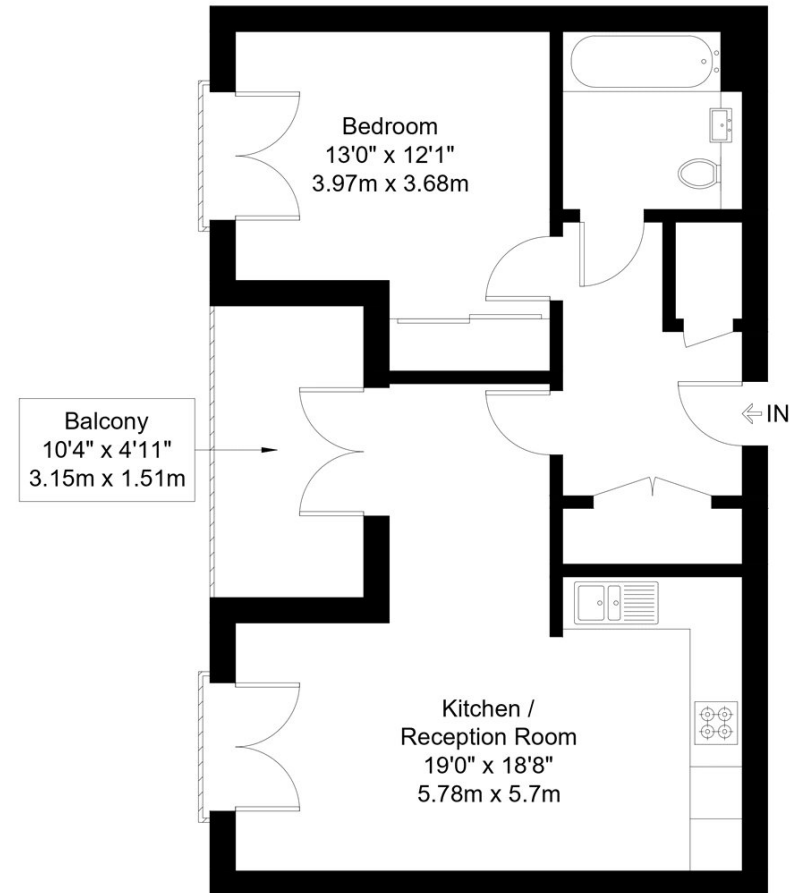

Fourth Floor

The Floor plan is not to scale and measurements and areas shown are approximate and therefore should be used for illustrative purposes only. The plan has been prepared in accordance with the RICS code of Measuring Practice and whilst we have confidence in the information produced it must not be relied on. Maximum lengths and widths are represented on the floor plan. If there is any aspect of particular importance, you should carry out or commission your own inspection of the property.

Copyright © BleuPlan

**Energy Performance Certificates**

