



**Naylor Building West, E1 7QL**

Price:  
£ 500,000

# Naylor Building West, E1 7QL

Price: £ 500,000 2 bedroom house

[View Property](#)

## OVERVIEW

Situated just moments from Aldgate East station, this well-proportioned two bedroom, two bathroom apartment spans approximately 770 sq ft and is ideally located within the heart of E1, a short walk from Brick Lane and Old Spitalfields Market.

Accessed via a secure gated entrance, the apartment opens into a spacious open-plan living and dining area, offering excellent natural light and a practical layout for modern living. The living space flows directly onto a light wooden patio garden, providing valuable outdoor space ideal for relaxing or entertaining.

## KEY FEATURES

- Two bedroom, two bathroom apartment extending to approx. 770 sq ft
- Secure gated development within the Naylor Building West
- Spacious open plan living and dining area
- Direct access to a private wooden patio garden
- Principal bedroom with en suite bathroom
- Well proportioned second double bedroom and family bathroom
- Moments from Aldgate East station and the City fringe
- Short walk to Brick Lane and Old Spitalfields Market

EBI  
EST  
1983

## Naylor Building

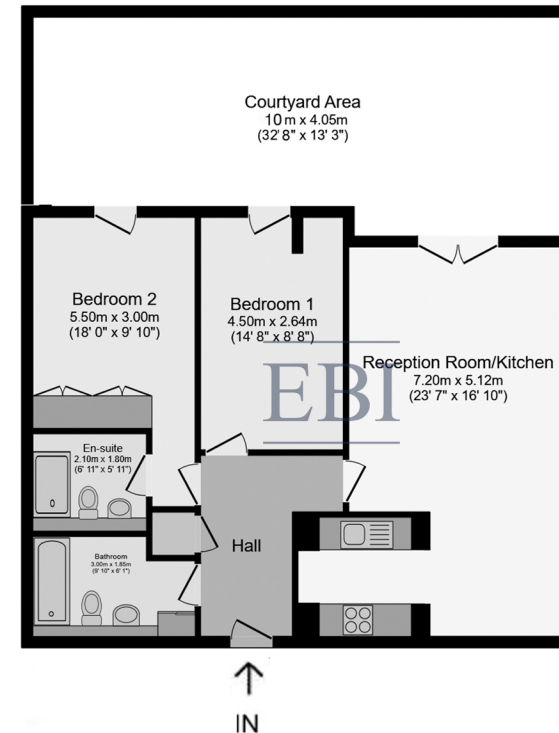

Ground Floor Plan

Floor area 74.0 sq.m. (797 sq.ft.)

Whilst every attempt has been made to ensure the accuracy of the floor plan contained here, measurements of doors, windows, rooms and any other items are approximated and no responsibility is taken for any error, omission or mis-statement. This plan is for illustrative purposes only and should be used as such by prospective purchaser. The service, system and appliances shown have not been tested and no guarantee as to their operability or efficiency can be given.

