



Naxos Building, 4 Hutchings Street, E14 8JR

Price:

£ 2,600 /pcm

Naxos Building, 4 Hutchings Street, E14 8JR

Price: £ 2,600 /pcm2 bedroom house

[View Property](#)

OVERVIEW

A superb two bedroom apartment in Naxos Building with full river view. The property features an designer open plan kitchen which leads onto the private balcony overlooking the river Thames , solid wood flooring, two large double bedroom with a built-in wardrobes, one bedroom en suite plus a further bathroom.

Naxos Building enjoys a prime location, just a 5-minute stroll from the vibrant heart of Canary Wharf. This bustling area offers a diverse array of restaurants, bars, and entertainment options, making it an ideal spot for both work and leisure. Residents of Naxos Building will appreciate the excellent transport links, with the DLR accessible via both South Quay and Canary Wharf stations, as well as the Jubilee Line. These connections provide quick and easy access to central London and other key destinations, enhancing the convenience and appeal of living in this dynamic neighborhood.

KEY FEATURES

- Available NOW
- Two bedrooms
- Direct river view
- Balcony
- Two bathrooms
- Furnished
- 24 hour concierge
- Gym access

EBI

Naxos Building

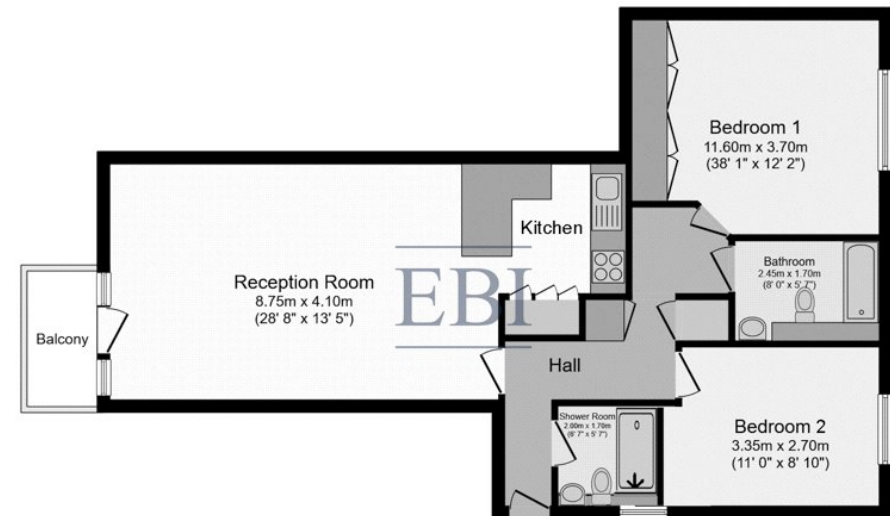

Floor Plan

Floor area 76.8 m² (827 sq.ft.)

Whilst every attempt has been made to ensure the accuracy of the floor plan contained here, measurements of doors, windows, rooms and any other items are approximated and no responsibility is taken for any error, omission or mis-statement. This plan is for illustrative purposes only and should be used as such by prospective purchaser. The service, system and appliances shown have not been tested and no guarantee as to their operability or efficiency can be given.

Energy Performance Certificates

