



Mercier Court, E16 2BG

Price:

£ 535,000

Mercier Court, E16 2BG

Price: £ 535,000 2 bedroom house

[View Property](#)

OVERVIEW

Two bedroom 8th floor apartment spread over (866 Sq. Ft) offering a further (438 Sq. Ft) dual aspect terrace area. The apartment makes for the perfect Buy To Let opportunity. Located in Anchor Building, Royal Wharf. E16

Estimated completion: Between September and October 2017

KEY FEATURES

- Furniture Pack Included
• 866 sqft Plus 438 sqft Terrace
• Sauna, Steam Room, Jacuzzi and Gym
• 25 metre swimming pool and hydrotherapy pool
• 10 year NHBC warranty
• Estimated Service charge: £3.20 per sqft
• Estimated Ground rent: £600 per annum
• Perfect Buy To Let Product
• Completion due: Between September and October 2017

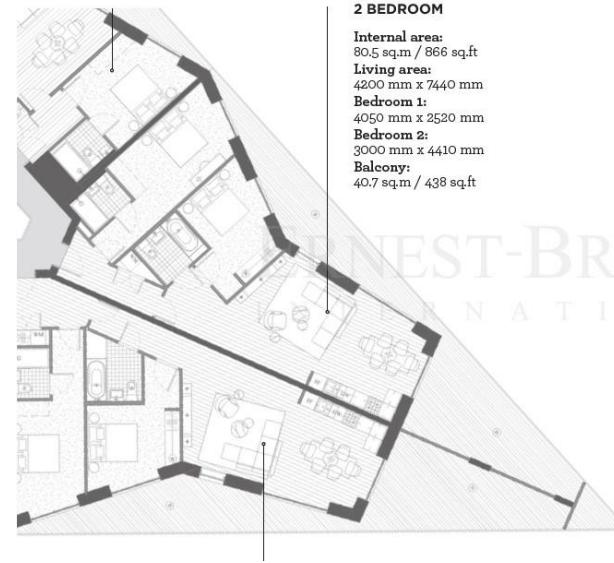

ROYAL WHARF
LONDON

ANCHOR BUILDING

LEVEL

08

LEGEND

C: Cupboard
W: Wardrobe
F: Fridge/Freezer
WM: Washer/Dryer
B: Balcony

NOTES

