



Maple Court, Alvey Street, SE17 2LN

Price:
£ 540,000

Maple Court, Alvey Street, SE17 2LN

Price: £ 540,000 2 bedroom house

[View Property](#)

OVERVIEW

Situated on the third floor of Maple Court, is the beautifully appointed two bedroom flat.

The apartment itself is comprised at over 790 Sq.Ft and further benefits from lift access and a communal garden space.

KEY FEATURES

- Two bedroom apartment
- Situated on the third floor
- Comprised at over 790 Sq. Ft
- Private balcony space
- Floor to ceiling windows
- Lift access
- Bugess Pak on your doorstep
- Tenure; leasehold 147 years
- Twenty minute walk to London Bridge
- EWS1 Compliant

Maple Court

Alvey Street, London, SE17 2LN
Tel: 020 7461 1111
Email: info@ernest-brooks.com

ERNEST-BROOKS
INTERNATIONAL

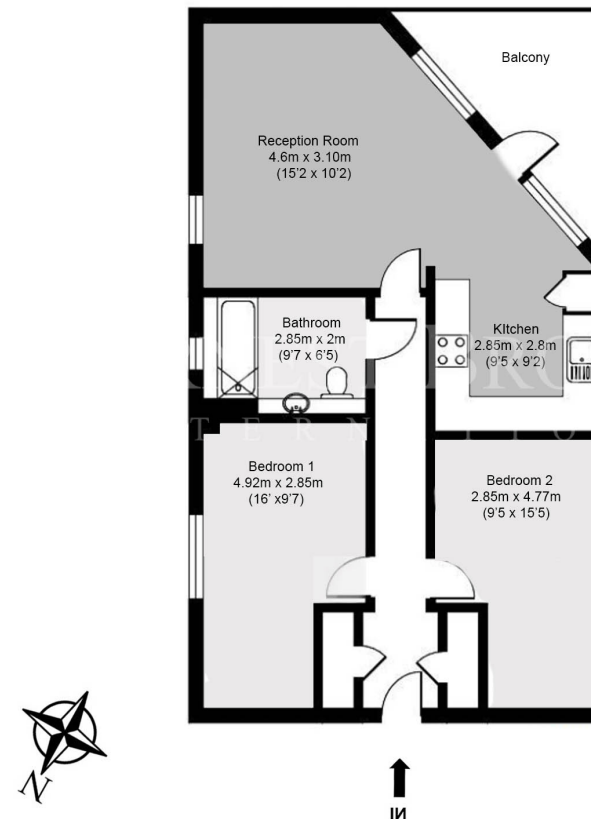

Third Floor

Floor area 74 sq.m. (798sq ft) approx

Whilst every attempt has been made to ensure the accuracy of the floor plan contained here, measurements of doors, windows, rooms and any other items are approximated and no responsibility is taken for any error, omission or mis-statement. This plan is for illustrative purposes only and should be used as such by prospective purchaser. The service, system and appliances shown have not been tested and no guarantee as to their operability or efficiency can be given.

Energy Performance Certificates

