



**Leven Wharf, Poplar, E14 0LN**

Price:  
£ 319,000

# Leven Wharf, Poplar, E14 0LN

Price: £ 319,000 1 bedroom house

[View Property](#)

## OVERVIEW

**\*FIRE SALE - BELOW COST PRICE\*** Well positioned 6th floor West facing apartment, boasting (549 Sq.Ft) with a West / South West facing terrace area. Just north of the docklands and two kilometres east of the City, Leven Wharf is at the heart of a superbly positioned residential area.

Leven Wharf development will offer its residents ample living space with easy access to Canary Wharf. 0.5 hectare of waterfront development is part of the important Poplar Riverside development zone, whose development has been boosted by its proximity to the city's 2012 Olympic City Park. Leven Wharf comprises 96 one, two and three bedroom apartments plus commercial floorspace in a nine-storey Y shaped block which overlooks the river to the north and the park to the south

## KEY FEATURES

- Sixth Floo One Bedoom Apatment549 sqft Plus Teace AeaWest Aspect10 Yea BLP WaantyGeat Investment PoductTenue: 999 yea leaseholdEst Sevice chage: u00a333 pe sqftEst Gound ent: u00a3300 pe annumCompletion due June 2018Not available on Help To Buy

TYPE A  
1 BEDROOM APARTMENTS:  
101, 201, 301, 401, 501, 601, 701  
1ST FLOOR  
2ND FLOOR  
3RD FLOOR  
4TH FLOOR  
5TH FLOOR  
6TH FLOOR  
7TH FLOOR

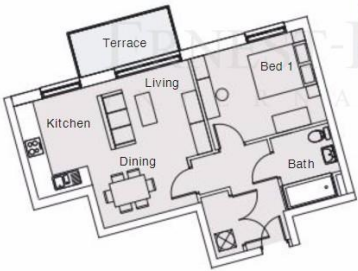

AREA: 51 sq m | 549 sq ft

Kitchen/Living/Dining Room	6.00 m x 4.70 m
Bedroom 1	3.85 m x 3.15 m
Bathroom	2.45 m x 2.00 m
Terrace	3.40 m x 1.50 m



