

ERNEST-BROOKS  
INTERNATIONAL

**Legacy Tower, 88 Great Eastern Road, E15 1DE**

Price:  
£ 450,000





# Legacy Tower, 88 Great Eastern Road, E15 1DE

Price: £ 450,000 1 bedroom house

[View Property](#)

## OVERVIEW

A stunning one bedroom apartment, situated on the 14th floor in Stratford's premier development, Legacy Tower.

Offering west views towards (Stratford City, Queen Elizabeth Olympic Park) & North over Hackney Marsh. Located in the absolutely stunning Stratford Central development. The apartment is comprising of a dual aspect facing lounge/kitchen/diner, a bathroom and master bedroom.

## KEY FEATURES

- One bedroom apartment
- Situated on the 14th floor
- Private Oversized Balcony
- Zoned under-floor heating
- Residents concierge services
- Private residents gymnasium
- Great investment area
- Phenomenal transport link - Crossrail Connection
- Just ten minutes from Canary Wharf
- Tenure: leasehold 250 years



View towards the Queen Elizabeth Olympic Park & Westfield Stratford City

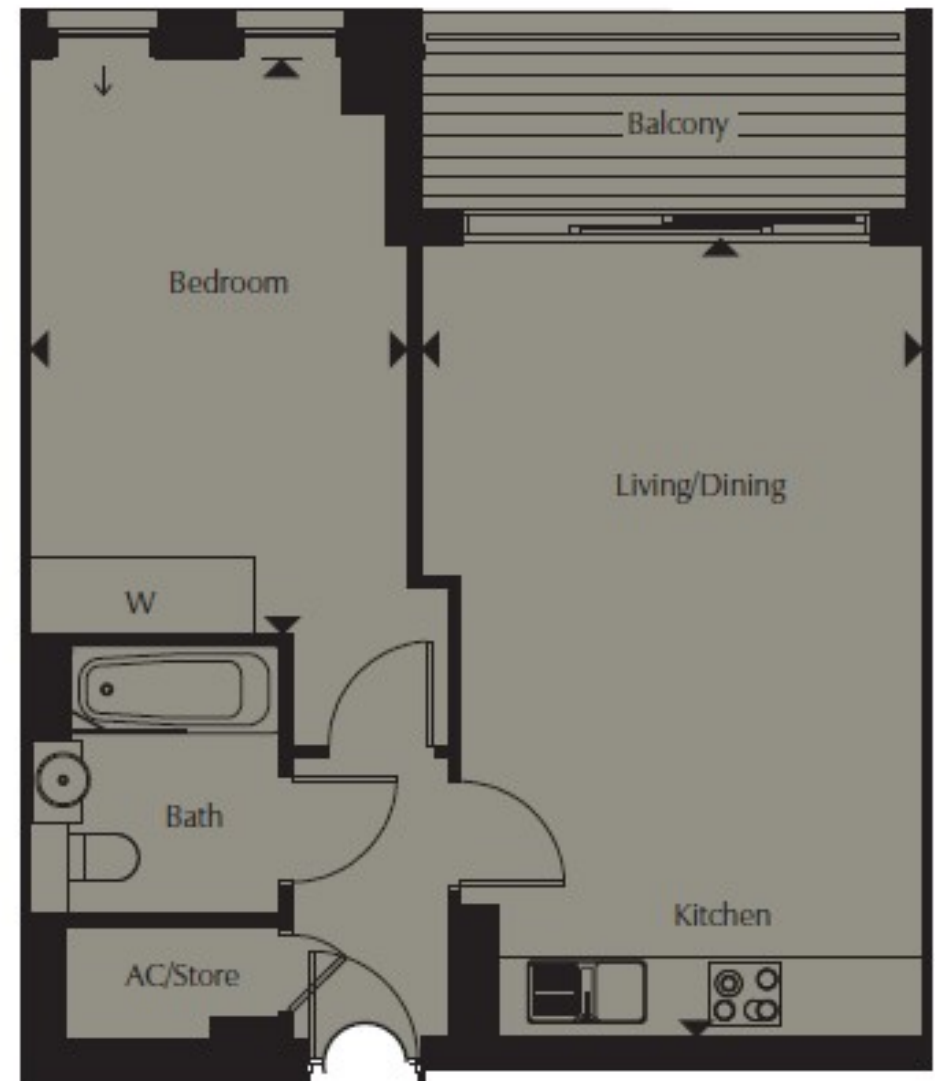

## APARTMENT

Kitchen/Living/Dining

6.42m x 4.04m

21'11" x 13'2"



