



Kingly Building, Woodberry Down, N4 2SB

Price:
£ 450,000

Kingly Building, Woodberry Down, N4 2SB

Price: £ 450,000 1 bedroom house

[View Property](#)

OVERVIEW

Luxury 6th floor apartment located in The Kingly Building, Woodberry Down, N4. The property offering (522 Sq. Ft) plus balcony. The development includes a 24hour concierge service, residence gymnasium, spa and swimming pool.

The development includes a 24hour concierge service, residence gymnasium, spa and swimming pool.

KEY FEATURES

- 6th Floor Apartment
24 Hour Concierge Services
Residents pool, gym and spa
Close to transport links
Developer : Berkeley Homes
Tenure (years) : 299
Service Charge : £4.79 psf par
Ground Rent : £350 par
Completion estimated Q3 2018.
Waterside location

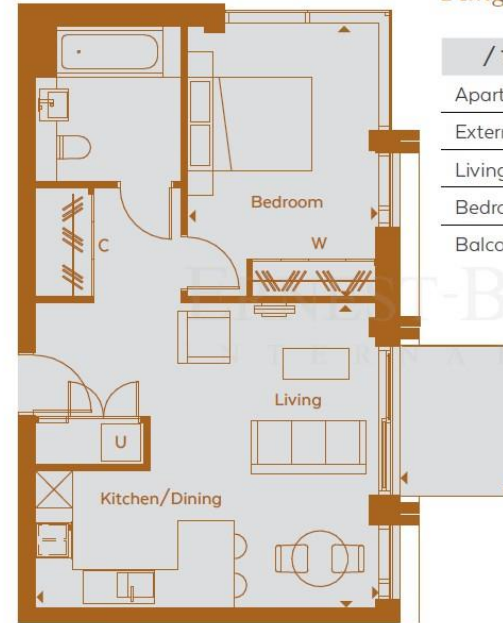

Kingly Building

/ 1 BED	575 sq ft	53.5 sqm
Apartment NIA	522 sq ft	48.5 sqm
External area	53 sq ft	5 sqm
Living area/KLD*	24'8" x 10'10"	7.55 x 3.32
Bedroom	15'7" x 11'1"	4.80 x 3.38
Balcony	8'0" x 6'9"	2.44 x 2.07



