



Kelson House, 10 Schooner Road, E16 2RN

Price:
£ 588,500

Kelson House, 10 Schooner Road, E16 2RN

Price: £ 588,500 2 bedroom house

[View Property](#)

OVERVIEW

Spacious (797 Sq. Ft) two bedroom plus two balcony apartment situated on the sixth floor of Kelson House in the Royal Wharf development!

With approximately 500m of direct south facing river frontage, Royal Wharf offers high-quality waterside living with stunning panoramic views. The scale of Royal Wharf offers the potential to create a new great estate for London. Not only does Royal Wharf offer a stunning south facing riverside promenade, but also has at its heart a new vibrant high street, beautiful riverside walkway, new streets, connecting parks and squares, a new school, shops, offices and riverside restaurants, catering for a population that is estimated to reach 10,000 by completion.

KEY FEATURES

- Swimming Pool

Kelson House

ERNEST-BROOKS
INTERNATIONAL

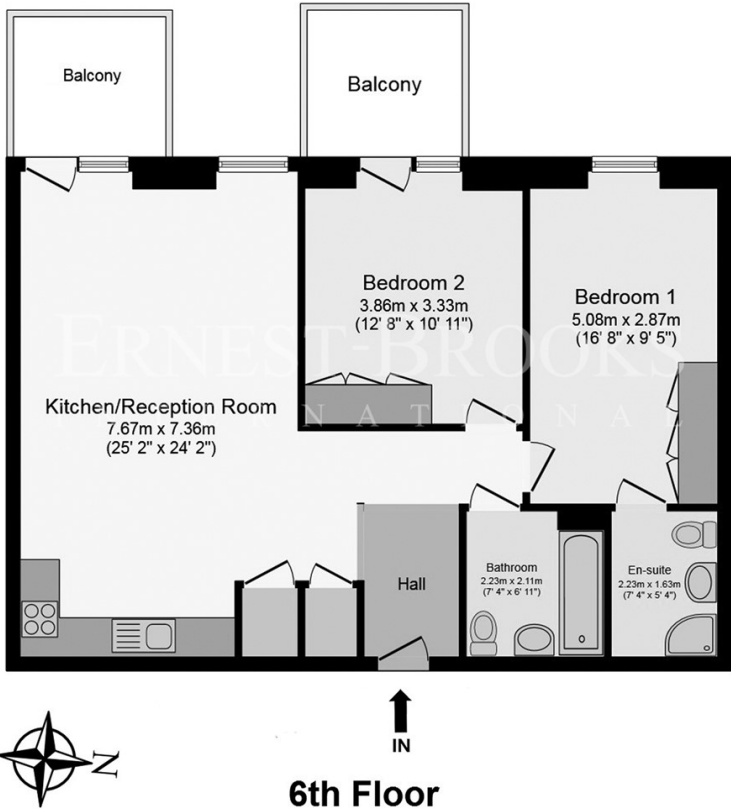

Energy Performance Certificates

Energy Efficiency Rating		
	Current	Potential
Very energy efficient - lower running costs		
(92+) A		

