



Island Row, Limehouse, E14 7HU

Price:
£ 485,000

Island Row, Limehouse, E14 7HU

Price: £ 485,000 3 bedroom house

[View Property](#)

OVERVIEW

Located within minutes of the Limehouse Basin, Island Row is a secluded development perfect for anyone looking for their first home or any investor looking to add to their portfolio.

Spread over 781 Sq.Ft with a southerly aspect this apartment has an abundance of natural light making the already well thought out apartment feel even more spacious.

KEY FEATURES

- Canalside living
- Secluded development
- Three double bedrooms
- South facing
- Optimised floorplan
- Bathroom recently refurbished
- Moments from Limehouse Basin
- Fantastic connectivity to City & Canary Wharf
- Long lease
- Chain-Free

Island Row, E14
Approx. Gross Internal Area 781 Sq Ft - 72.56 Sq M

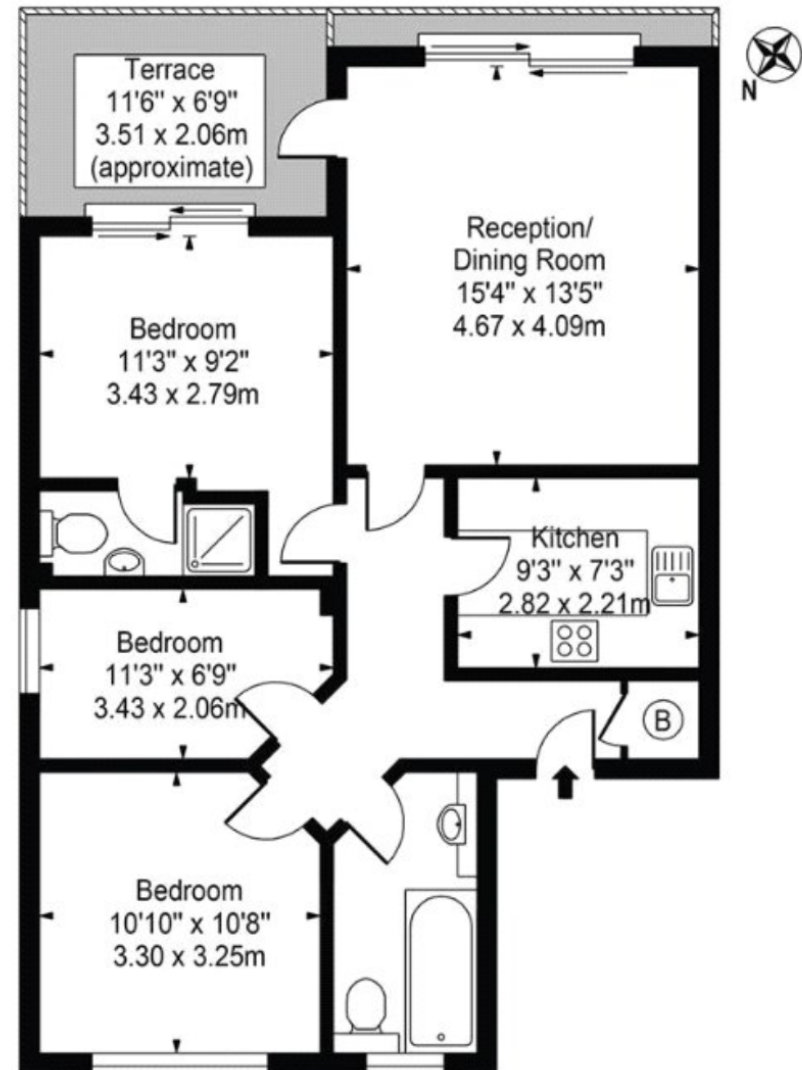

Raised Ground Floor

For Illustration Purposes Only - Not To Scale

This floor plan should be used as a general outline for guidance only and does not constitute in whole or in part an offer or contract. Any intending purchaser or lessee should satisfy themselves by inspection, searches, enquiries and full survey as to the correctness of each statement. Any areas, measurements or distances quoted are approximate and should not be used to value a property or be the basis of any sale or let.

Energy Performance Certificates

