



Frances Street, Woolwich, SE18 5JU

Price:  
£ 250,000





# Frances Street, Woolwich, SE18 5JU

Price: £ 250,000 2 bedroom house

[View Property](#)

## OVERVIEW

This purpose-built local authority block is located in the heart of Woolwich yet offers a calm and secluded feel.

This illuminated apartment set on the twelfth floor incorporates a spacious lounge room area, a separate vivid kitchen and a private balcony offering spectacular views of the Canary Wharf skyline.

## KEY FEATURES

- Spectacular Views of Canary Wharf Skyline
- 12th Floor
- Two Double Bedrooms
- One Bathroom
- Purpose-built Block
- Spacious Living Area
- Ample Storage
- Impeccable Finish
- Close Proximity of Shopping Amenities
- Short Walking Distance to Woolwich Dockyard Station

## Frances Street

ERNEST-BROOKS  
INTERNATIONAL

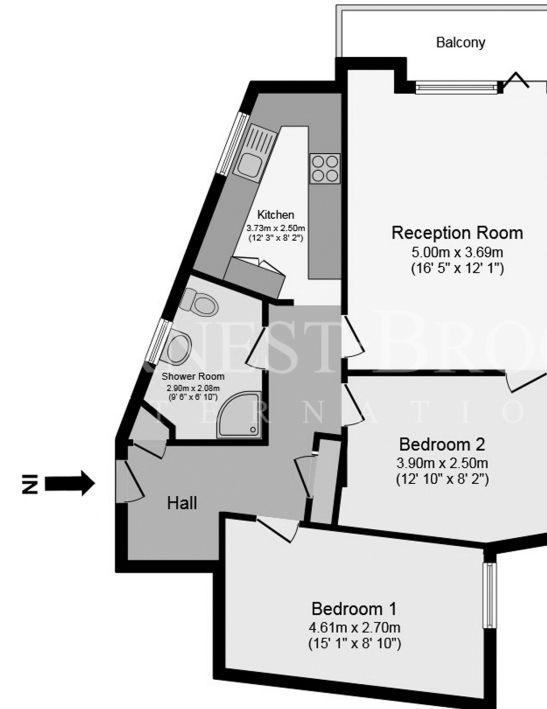

### 12th Floor Plan

Floor area 67.4 sq.m. (726 sq.ft.) approx



Whilst every attempt has been made to ensure the accuracy of the floor plan contained here, measurements of doors, windows, rooms and any other items are approximated and no responsibility is taken for any error, omission or mis-statement. This plan is for illustrative purposes only and should be used as such by prospective purchaser. The service, system and appliances shown have not been tested and no guarantee as to their operability or efficiency can be given.

**Energy Performance Certificates**

