

ERNEST-BROOK
INTERNATIONAL

Elizabeth House, Elizabeth Drive, SM7 2FE

Price:
£ 332,500

Elizabeth House, Elizabeth Drive, SM7 2FE

Price: £ 332,500 2 bedroom house

[View Property](#)

OVERVIEW

Well-presented spacious apartment located in the prestigious Elizabeth Drive, a gated development surrounded by 28 acres of woodland communal grounds and gardens.

This bright and airy apartment sits in excellent condition, some benefits on offer include an allocated parking space, security entrance phones, manicured communal gardens, a Japanese water garden, communal BBQ area and use of the recently refurbished tennis courts. Only 5 apartments are accessed through the private entrance with lobby area, and being the only apartment on the top floor privacy is ensured. The estate with CCTV security is accessed via electronically-controlled security gates and a 600m long sweeping driveway fringed with floral decor. The surrounding countryside is ideal for walking, running and riding.

KEY FEATURES

- Tennis Court

Elizabeth House

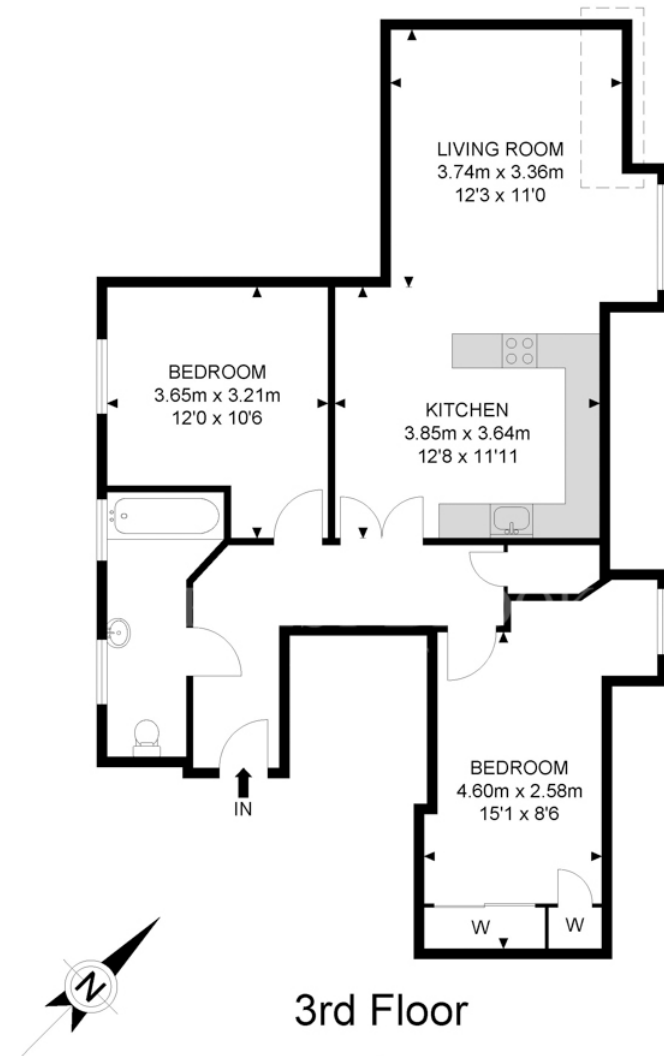

SP
SPACE PHOTO

APPROX. GROSS INTERNAL FLOOR AREA 689.96 SQ FT / 64.10 SQM
RESTRICTED HEIGHT AREA 26.90 SQ FT / 2.50 SQM

Whilst every attempt has been made to ensure the accuracy of the floor plan contained here, measurements of doors, windows, rooms and any other items are approximated and no responsibility is taken for any error, omission or mis-statement. This plan is for illustrative purposes only and should be used as such by any prospective purchaser. The service, system and appliances shown have not been tested and no guarantee as to their operability or efficiency can be given.

© SpacePhoto

Photography and Floor Plan

Energy Performance Certificates

