



City Court, Legacy Wharf, E15 2PF

Price:

£ 479,000

City Court, Legacy Wharf, E15 2PF

Price: £ 479,000 2 bedroom house

[View Property](#)

OVERVIEW

Luxury two bedroom river facing apartment! (866 Sq. Ft) spread over (778 Sq. Ft) plus large (88 Sq. Ft) terrace area! Legacy Wharf is a contemporary development of new homes in Stratford, an increasingly sought-after residential area of east London that has in recent years undergone significant regeneration and benefits from a wealth of local amenities. The development includes commercial and retail premises at ground level, as well as landscaped podium gardens, a gym and a concierge service. Low service charge and ground rent make this an IDEAL investment product for buy to let or first home in a prime residential location!

NO HELP TO BUY

KEY FEATURES

- Rive Facing!
- Residents fitness cente & communal gadens
- Residents conciege sevices
- Residents secue cycle stoage
- Close to multiple tanspot links
- Completion due Q2 2019
- Tenue: 999 yeas fom August 2017
- Est Sevice chage: u00a32.5 psf pa
- Est Gound Rent: u00a3350 pa
- NO HELP TO BUY

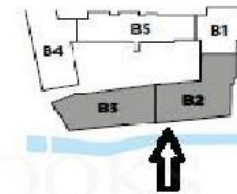

TYPE 2B 4P 07

Two Bedroom Apartment, plots 47, (57), (67), 77, 107, 113, 114, 121, 122, 129, 130 & 196

| | | |
|--------------------------------|-----------------|---------------|
| Kitchen/Living/ Dining Room | 5.630m x 5.100m | 18'6" x 16'9" |
| Bedroom 1 | 5.715m x 2.750m | 18'9" x 9'0" |
| Bedroom 2 | 3.415m x 3.100m | 11'2" x 10'2" |

