



**Charrington Tower, New Providence Wharf, Biscayne Avenue, E14 9BQ**

Price:  
£ 325,000





# Charrington Tower, New Providence Wharf, Biscayne Avenue, E14 9BQ

Price: £ 325,000 1 bedroom house

[View Property](#)

EBI

## Charrington Tower

### OVERVIEW

This stylish studio apartment is located on the 31st floor of Charrington Tower, part of the highly sought-after Providence Wharf development, just south of Canary Wharf.

The apartment features a bright and well-presented open-plan reception and dining area with wooden flooring, leading into a fully fitted modern kitchen with integrated appliances. Floor-to-ceiling windows flood the space with natural light and offer stunning panoramic views.

### KEY FEATURES

- 31st floor position with panoramic skyline views
- Stylish and well-designed studio suite layout
- Floor-to-ceiling windows with abundant natural light
- Fully equipped residents' health club and modern gym
- Luxury on-site swimming pool with spa facilities
- Stunning panoramic views across London skyline
- 24-hour concierge service for residents' convenience
- Business centre and exclusive 43rd floor Sky Lounge

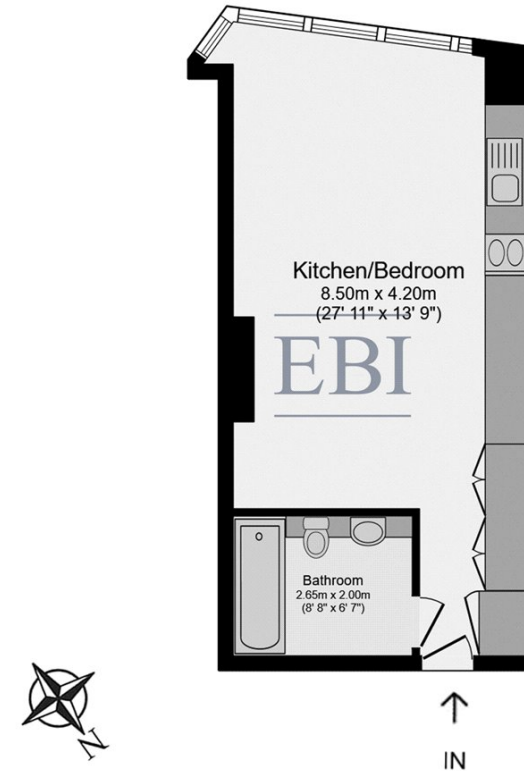

Thirty First Floor

Floor area 35.0 m<sup>2</sup> ( 377 sq.ft.)

Whilst every attempt has been made to ensure the accuracy of the floor plan contained here, measurements of doors, windows, rooms and any other items are approximated and no responsibility is taken for any error, omission or mis-statement. This plan is for illustrative purposes only and should be used as such by prospective purchaser. The service, system and appliances shown have not been tested and no guarantee as to their operability or efficiency can be given.

Energy Performance Certificates

