



**Chamberlain Court, Silwood Street, SE16 2AZ**

Price:  
£ 560,000





# Chamberlain Court, Silwood Street, SE16 2AZ

Price: £ 560,000 3 bedroom house

[View Property](#)

## OVERVIEW

Spectacular three bedroom apartment set on the first floor of the popular Chamberlain Court in Bermondsey.

Spread over an impressive 1010sqft, the modern apartment boasts three double bedrooms with the master bedroom offering built in storage & en suite bathroom. The fully fitted kitchen has built in appliances and a fantastic breakfast bar. The open plan lounge is has a great modern finish and offers a dining area as well. The private balcony illuminates the room and offers brilliant outdoor space.

## KEY FEATURES

- First floor
- Modern development
- Three double bedrooms
- Two bathrooms including en suite
- Over 1000sqft
- Fully fitted kitchen
- Stunning open plan lounge
- Private balcony
- Resident parking
- Perfectly located for transport links



Chamberlain Court, SE16

CAPTURE DATE 30/04/2021 LASER SCAN POINTS 2,668,369

GROSS INTERNAL AREA  
93.89 sqm / 1010.62 sqft

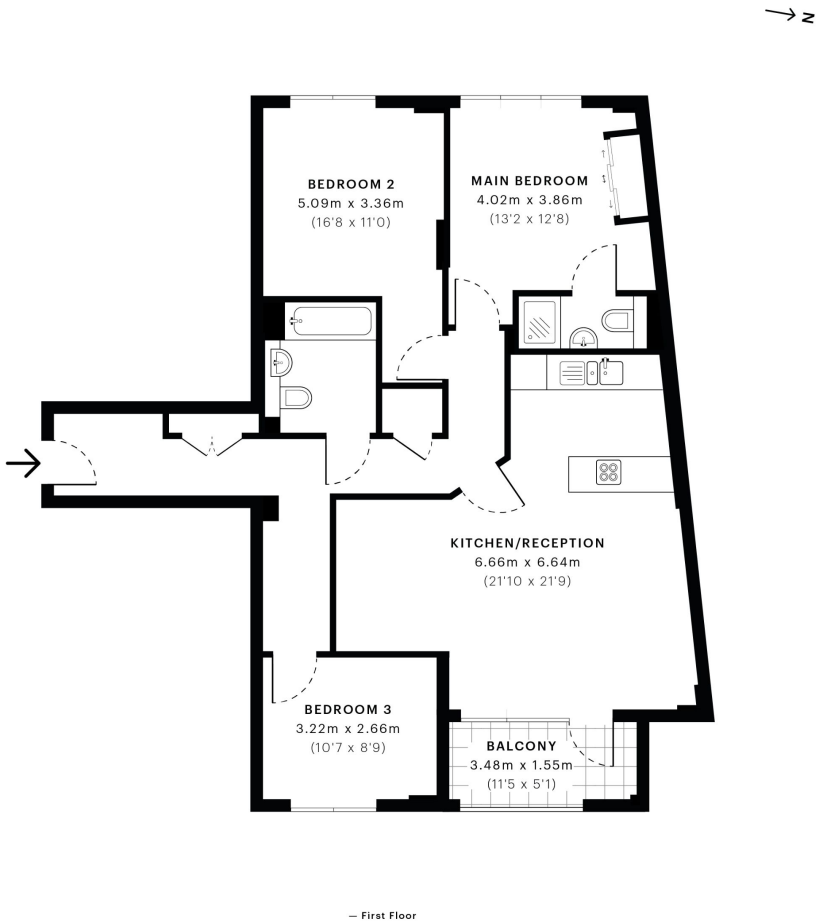

GROSS INTERNAL AREA (GIA)  
The footprint of the property  
93.89 sqm / 1010.62 sqft

NET INTERNAL AREA (NIA)  
Excludes walls and external features  
Includes washrooms, restricted head height  
89.58 sqm / 964.23 sqft

EXTERNAL STRUCTURAL FEATURES  
Balconies, terraces, verandas etc.  
5.28 sqm / 56.83 sqft

RESTRICTED HEAD HEIGHT  
Limited use area under 1.5 m  
0.00 sqm / 0.00 sqft



Spec Verified floor plans are produced in accordance with Royal Institution of Chartered Surveyors' Property Measurement Standards. Plots and gardens are illustrative only and excluded from all area calculations. Due to rounding, numbers may not add up precisely. All measurements shown for the individual room lengths and widths are the maximum points of measurements captured in the scan.

IPMS 3B RESIDENTIAL 99.85 sqm / 1074.78 sqft  
IPMS 3C RESIDENTIAL 95.89 sqm / 1032.15 sqft  
SPEC ID: 608a950c4048510dde8a7c12

## Energy Performance Certificates



