



**Calders Wharf, 4A Saunders Ness Road, E14 3PS**

Price:  
£ 425,000





## Calders Wharf, 4A Saunders Ness Road, E14 3PS

Price: £ 425,000 1 bedroom house

[View Property](#)

### OVERVIEW

Set within the peaceful riverside surroundings of Calders Wharf, this spacious one-bedroom apartment offers contemporary Isle of Dogs living moments from excellent transport links and scenic Thames-side walks. Positioned on the second floor and extending to approximately 724 sq ft, the property combines generous proportions, natural light, and strong lifestyle appeal in a highly connected Docklands location.

The apartment features a bright and well-proportioned open-plan living and dining area, enhanced by large windows and direct access to a private east-facing balcony. The outdoor space provides an ideal setting for morning coffee or relaxing while enjoying the peaceful surroundings and early sunlight. The spacious layout offers excellent versatility for both entertaining and everyday living.

### KEY FEATURES

- One-bedroom second floor apartment
- Approx. 724 sq ft total space
- Private east-facing balcony
- Bright open-plan living area
- Modern fitted kitchen
- Spacious double bedroom
- Close to Island Gardens DLR
- Excellent Canary Wharf connectivity
- Peaceful Isle of Dogs setting
- Strong lifestyle and investment appeal

## Saunders Ness Road, E14

Approx Gross Internal Area = 61.5 sq m / 662 sq ft

Balcony = 5.8 sq m / 62 sq ft

Total = 67.3 sq m / 724 sq ft

# EBI

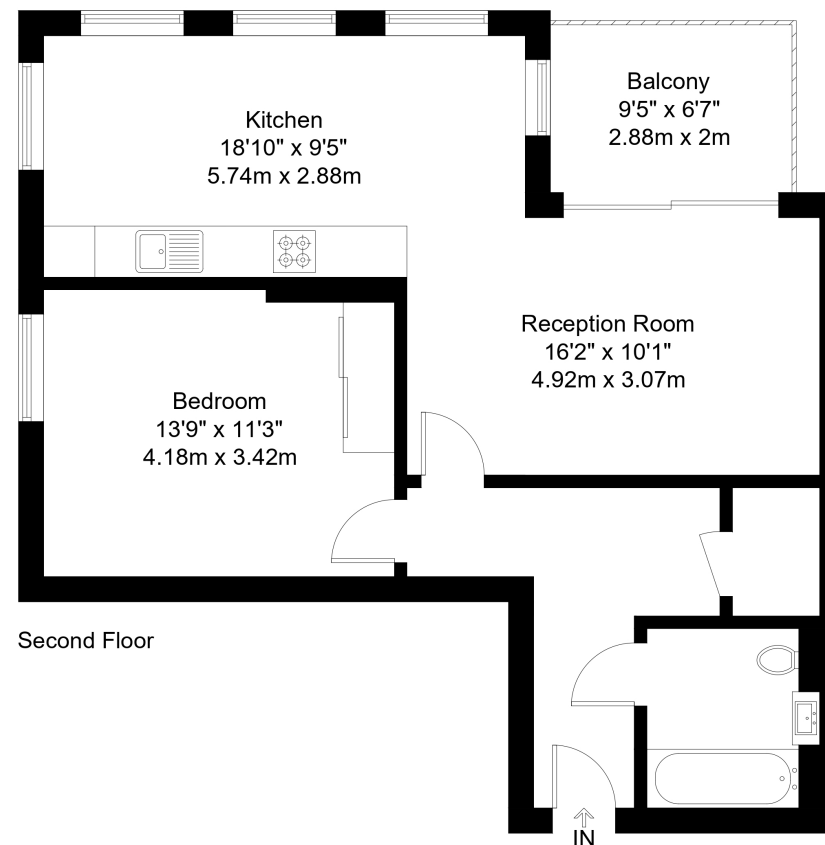
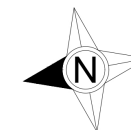

The Floor plan is not to scale and measurements and areas shown are approximate and therefore should be used for illustrative purposes only. The plan has been prepared in accordance with the RICS code of Measuring Practice and whilst we have confidence in the information produced it must not be relied on. Maximum lengths and widths are represented on the floor plan. If there is any aspect of particular importance, you should carry out or commission your own inspection of the property.

Copyright @ BleuPlan

**Energy Performance Certificates**

