

A large, semi-transparent watermark of the letters 'EBI' in a serif font, centered over the middle of the image.

Bruges Place, Camden Town, NW1 0TL

Price:
£ 1,950 /pcm

Bruges Place, Camden Town, NW1 0TL

Price: £ 1,950 /pcm

[View Property](#)

OVERVIEW

Bright and well-presented studio apartment in the heart of Camden, offered furnished and ready to move into. With convenient access to UCL and the London School of Economics.

The property benefits from excellent transport links, with Camden Town Underground Station (Northern Line, Zone 2) and Camden Road Overground Station both nearby, providing easy access to Central London and the City. Situated within walking distance of Camden's lively high street, you'll find a wide range of shops, bars, and restaurants right on your doorstep.

KEY FEATURES

- Studio
- Furnished
- 280sqft
- Modern fixtures and fittings
- Close to Google Head Office
- 5 mins to Kings Cross
- Less than 10 minutes to Central London
- Regents Park nearby
- Within walking distance to local amenities

Bruges Place, NW1

Approx Gross Internal Area = 25.9 sq m / 279 sq ft

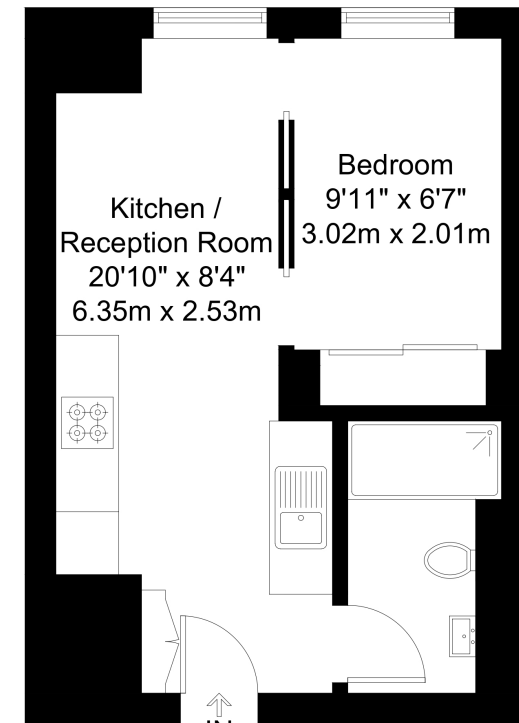

Second Floor

The Floor plan is not to scale and measurements and areas shown are approximate and therefore should be used for illustrative purposes only. The plan has been prepared in accordance with the RICS code of Measuring Practice and whilst we have confidence in the information produced it must not be relied on. Maximum lengths and widths are represented on the floor plan. If there is any aspect of particular importance, you should carry out or commission your own inspection of the property.

Copyright © BleuPlan

