



**Arena Tower, 25 Crossharbour Plaza, E14 9SS**

Price:

£ 475,000

# Arena Tower, 25 Crossharbour Plaza, E14 9SS

Price: £ 475,000 1 bedroom house

[View Property](#)

## OVERVIEW

Set on the 20th floor of the landmark Arena Tower, this well presented one bedroom apartment benefits from a large private balcony and impressive far-reaching views across Canary Wharf and beyond.

The apartment offers a bright and contemporary living space with a modern open plan kitchen fitted with fully integrated SMEG appliances and floor to ceiling windows that allow excellent natural light throughout. The bedroom is generously proportioned and features a built-in wardrobe, while the sleek bathroom is finished to a high standard and benefits from underfloor heating.

## KEY FEATURES

- One-bedroom apartment on the 20th floor with views
- Private balcony overlooking Canary Wharf skyline
- Bright open-plan living with floor-to-ceiling windows
- Modern kitchen with fully integrated SMEG appliances
- Spacious bedroom with built-in wardrobe
- 24-hour concierge for security and convenience
- Gym, swimming pool, and private cinema access
- EWS1 compliant with 980-year lease
- Close to Crossharbour and South Quay DLR stations
- 0.8 miles from Canary Wharf Jubilee Line station

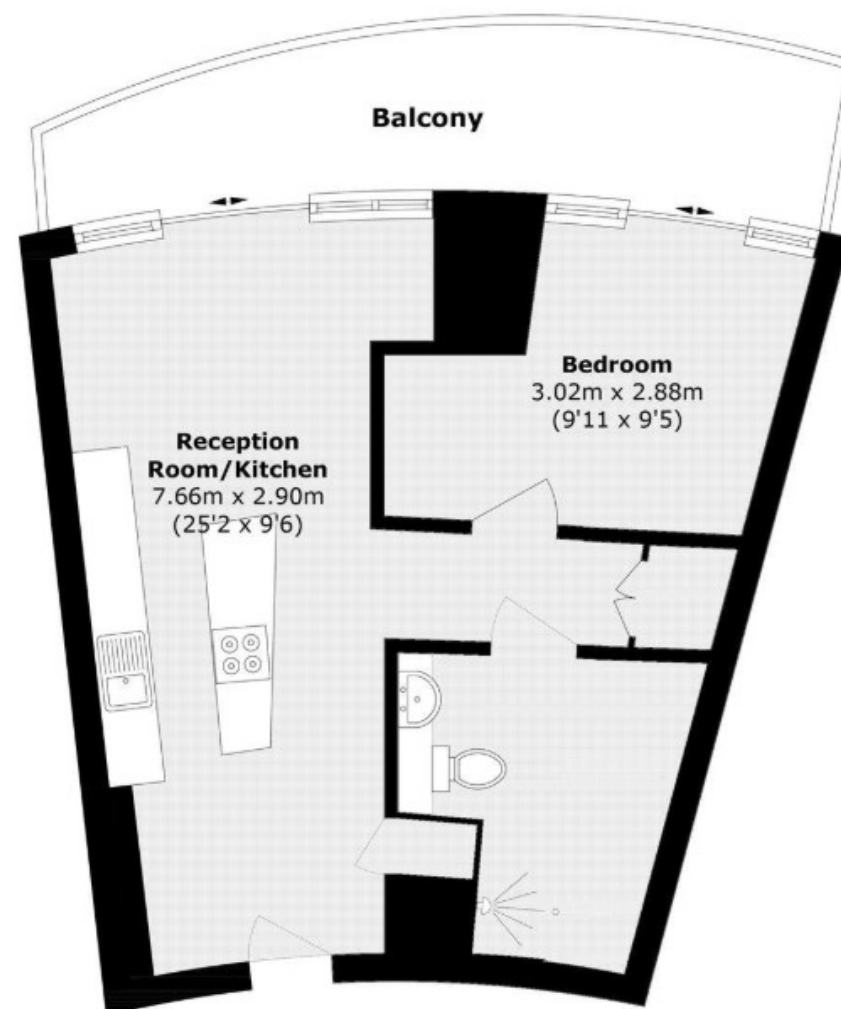

Total area (approx.): 52.0 sq. m (559.7 sq. ft)  
Balcony area (approx.): 15.5 sq. m (166.8 sq. ft)

