

Antilles Bay Apartments, 3 Lawn House Close, E14 9YG

Price:
£ 600,000

Antilles Bay Apartments, 3 Lawn House Close, E14 9YG

Price: £ 600,000 2 bedroom house

[View Property](#)

OVERVIEW

This beautifully presented two-bedroom, two-bathroom apartment spans approximately 872 sq ft and offers a bright, contemporary living space with a well-balanced layout. The open-plan reception and kitchen area leads onto a private balcony overlooking the tranquil South Dock, providing an ideal setting for morning coffee or evening relaxation.

Situated within a well-maintained waterside development, residents benefit from a peaceful setting moments from the energy of Canary Wharf. The development offers secure allocated parking and the added advantage of a share of freehold, ensuring long-term value and stability for homeowners.

KEY FEATURES

- Spacious two-bedroom, two-bathroom apartment spanning approximately 770 sq ft
- Private balcony with serene views over South Dock
- Bright open-plan reception and kitchen with modern integrated appliances
- Includes parking
- Set within a well-maintained waterside development close to local amenities
- Just a short walk from Canary Wharf's shopping, dining, and entertainment hub
- Excellent transport links via Elizabeth Line, Jubilee Line, and DLR
- Ideal for professionals or investors seeking prime E14 living with dockside tranquillity

Antilles Bay Apartments, E14

Approx Gross Internal Area = 77.8 sq m / 837 sq ft

Balcony = 3.2 sq m / 34 sq ft

Total = 81 sq m / 872 sq ft

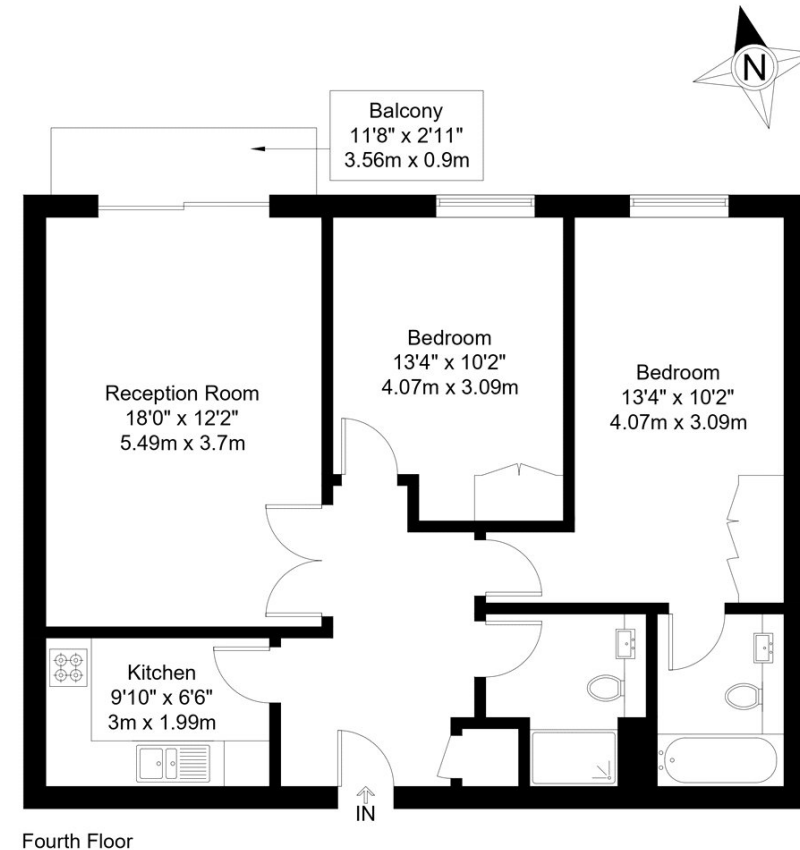

The Floor plan is not to scale and measurements and areas shown are approximate and therefore should be used for illustrative purposes only. The plan has been prepared in accordance with the RICS code of Measuring Practice and whilst we have confidence in the information produced it must not be relied on. Maximum lengths and widths are represented on the floor plan. If there is any aspect of particular importance, you should carry out or commission your own inspection of the property.
Copyright © BleuPlan

Energy Performance Certificates

