



**Antilles Bay Apartments, 3 Lawn House Close, E14 9YG**

Price:  
£ 575,000





## Antilles Bay Apartments, 3 Lawn House Close, E14 9YG

Price: £ 575,000 2 bedroom house

[View Property](#)

### OVERVIEW

This beautifully presented two-bedroom, two-bathroom apartment offers approximately 872 sq ft of contemporary living space with a thoughtfully designed, well-balanced layout. The open-plan reception and kitchen area is flooded with natural light and opens onto a private balcony overlooking the serene South Dock - the perfect spot for morning coffee or unwinding in the evening.

Located within a meticulously maintained waterside development, the property benefits from a peaceful environment while remaining just moments from the energy of Canary Wharf. Residents enjoy secure allocated parking and the added advantage of a share of freehold, providing long-term stability and value.

### KEY FEATURES

- Spacious two-bedroom, two-bathroom apartment, approx. 770 sq ft
- Private balcony with tranquil views over South Dock
- Bright open-plan reception and modern kitchen with integrated appliances
- Includes secure allocated parking within the development
- Set in a well-maintained waterside location near local amenities
- Short walk to Canary Wharf's shops, restaurants, and entertainment
- Excellent transport links via Elizabeth Line, Jubilee Line, and DLR
- Ideal for professionals or investors seeking prime E14 living

## Antilles Bay Apartments, E14

Approx Gross Internal Area = 77.8 sq m / 837 sq ft

Balcony = 3.2 sq m / 34 sq ft

Total = 81 sq m / 872 sq ft

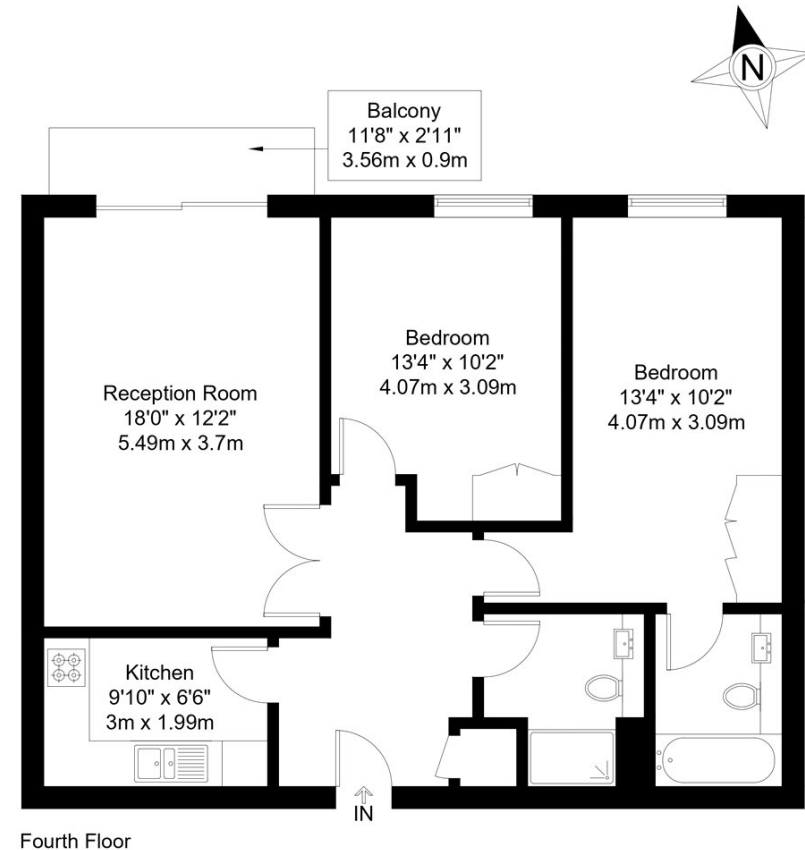

The Floor plan is not to scale and measurements and areas shown are approximate and therefore should be used for illustrative purposes only. The plan has been prepared in accordance with the RICS code of Measuring Practice and whilst we have confidence in the information produced it must not be relied on. Maximum lengths and widths are represented on the floor plan. If there is any aspect of particular importance, you should carry out or commission your own inspection of the property.  
Copyright © BleuPlan

**Energy Performance Certificates**



