

ERNEST BROOKS
INTERIOR DESIGN

95 Chelsea Court, Elm Park Gardens, SW10 9QW

Price:
£ 650,000

95 Chelsea Court, Elm Park Gardens, SW10 9QW

Price: £ 650,000 1 bedroom house

[View Property](#)

OVERVIEW

Within this impressive building situated only moments away from one of the most fashionable streets of London, King's Road sits this striking one bedroom apartment.

Situated on the fifth floor the apartment offers a sophisticated reception room along with an exceptional quality of finish bedroom. This character-filled home incorporates a modern lounge and separate fully fitted kitchen with integrated appliances and ample fitted storage.

KEY FEATURES

- 5th Floor
- One double bedroom
- Modern living room
- Separate kitchen
- Sleek bathroom
- Lift
- Communal Gardens
- Prime West London location
- Eclectic array of local bars and restaurants
- 145 year lease

Elm Park Gardens

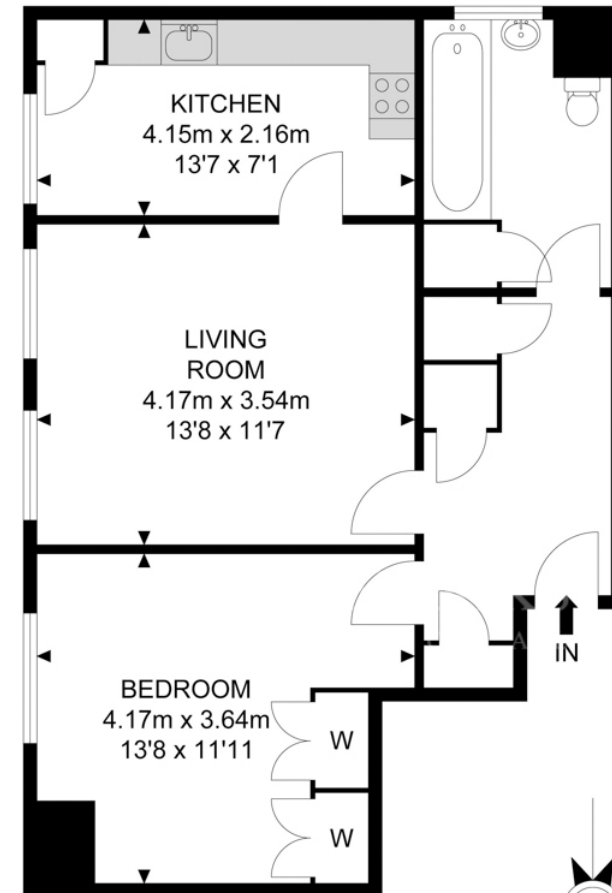

5th Floor



APPROX. GROSS INTERNAL FLOOR AREA 576.94 SQ FT / 53.60 SQM

Whilst every attempt has been made to ensure the accuracy of the floor plan contained here, measurements of doors, windows, rooms and any other items are approximated and no responsibility is taken for any error, omission or mis-statement. This plan is for illustrative purposes only and should be used as such by any prospective purchaser. The service, system and appliances shown have not been tested and no guarantee as to their operability or efficiency can be given.

© SpacePhoto

Photography and Floor Plan

Energy Performance Certificates

