

**29 Forge Square, Isle Of Dogs, E14 3GX**

Price:  
£ 2,100 /pcm

## 29 Forge Square, Isle Of Dogs, E14 3GX

Price: £ 2,100 /pcm2 bedroom house

[View Property](#)

### OVERVIEW

Situated on the fourth floor, this apartment offers approximately 642 sq ft of thoughtfully designed living space. The open-plan reception room features floor-to-ceiling windows that bathe the interior in natural light, with direct access to a private balcony for enjoying the outdoors. The contemporary kitchen includes integrated appliances, plentiful storage, and generous worktop space.

The primary bedroom benefits from built-in wardrobes and an en suite shower room. A well-proportioned second bedroom sits nearby, with a family bathroom conveniently positioned off the hallway.

### KEY FEATURES

- Two bedroom
- Two bathroom
- Furnished
- 4th floor
- Balcony
- 625sqft
- Concierge
- Excellent links to DLR Stations

## Forge Square, E14

Approx Gross Internal Area = 60.8 sq m / 654 sq ft

Balcony = 2.3 sq m / 25 sq ft

Total = 63.1 sq m / 679 sq ft

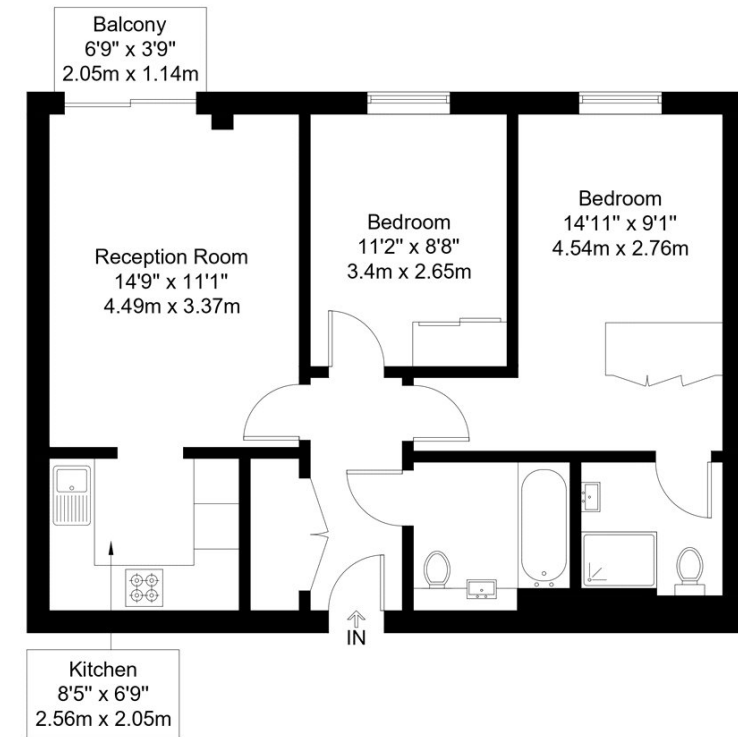

Fourth Floor

The Floor plan is not to scale and measurements and areas shown are approximate and therefore should be used for illustrative purposes only. The plan has been prepared in accordance with the RICS code of Measuring Practice and whilst we have confidence in the information produced it must not be relied on. Maximum lengths and widths are represented on the floor plan. If there is any aspect of particular importance, you should carry out or commission your own inspection of the property.  
Copyright © BleuPlan



