



2 Cutter Lane, SE10 0ZT

Price:
£ 2,200 /pcm

2 Cutter Lane, SE10 0ZT

Price: £ 2,200 /pcm1 bedroom house

[View Property](#)

OVERVIEW

A stunning modern one-bedroom apartment located in No.5 Upper Riverside, on the Greenwich Peninsula - offered fully furnished.

This ground-floor apartment benefits from a large private terrace and access to an exceptional range of resident amenities, including a residents' swimming pool, multiple gyms, roof terraces, 24-hour concierge, and a private cinema room.

KEY FEATURES

- One bedroom
- Furnished
- Private terrace
- Concierge
- Resident gym
- Swimming pool
- Cinema room
- Excellent transport links

Upper Riverside, SE10

Approx Gross Internal Area = 48.4 sq m / 521 sq ft

Terrace = 12.5 sq m / 135 sq ft

Total = 60.9 sq m / 656 sq ft

EBI

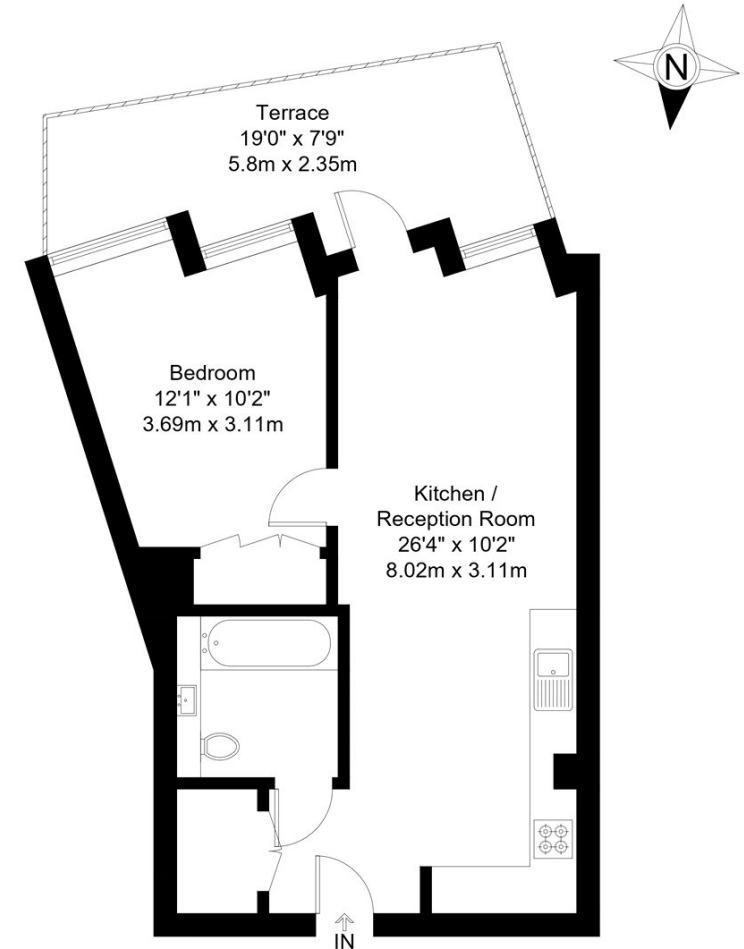

Upper Ground Floor

The Floor plan is not to scale and measurements and areas shown are approximate and therefore should be used for illustrative purposes only. The plan has been prepared in accordance with the RICS code of Measuring Practice and whilst we have confidence in the information produced it must not be relied on. Maximum lengths and widths are represented on the floor plan. If there is any aspect of particular importance, you should carry out or commission your own inspection of the property.

Copyright @ BleuPlan

