



**18 Cutter Lane, Greenwich Peninsula, SE10 0YD**

Price:  
£ 3,000 /pcm

# 18 Cutter Lane, Greenwich Peninsula, SE10 0YD

Price: £ 3,000 /pcm2 bedroom house

[View Property](#)

## OVERVIEW

Situated within the highly regarded Upper Riverside development on the Greenwich Peninsula, this beautifully presented furnished apartment offers contemporary riverside living in one of South East London's most exciting and fast-evolving neighbourhoods. Designed with modern lifestyles in mind, the development combines striking architecture, exceptional amenities and a prime waterside setting.

The two bedroom apartment features a well-balanced open-plan layout, maximising natural light through floor-to-ceiling glazing and creating a bright, airy living environment. The reception and dining space is thoughtfully arranged and furnished to a high standard, offering a comfortable and stylish home ideal for professionals seeking quality and convenience in Zone 2.

## KEY FEATURES

- Two double bedroom
- Two luxury bathrooms
- Private balcony with river views
- Open plan living and kitchen space
- Floor to ceiling windows throughout
- Exclusive residents club facilities access
- Swimming pool, gym and spa facilities
- 24 hour concierge and secure entry
- Moments from North Greenwich station
- Close to O2 and local amenities

# Cutter Lane, SE10

Approx Gross Internal Area = 72.35 sq m / 779 sq ft

Balcony = 3.19 sq m / 34 sq ft

Total = 75.54 sq m / 813 sq ft

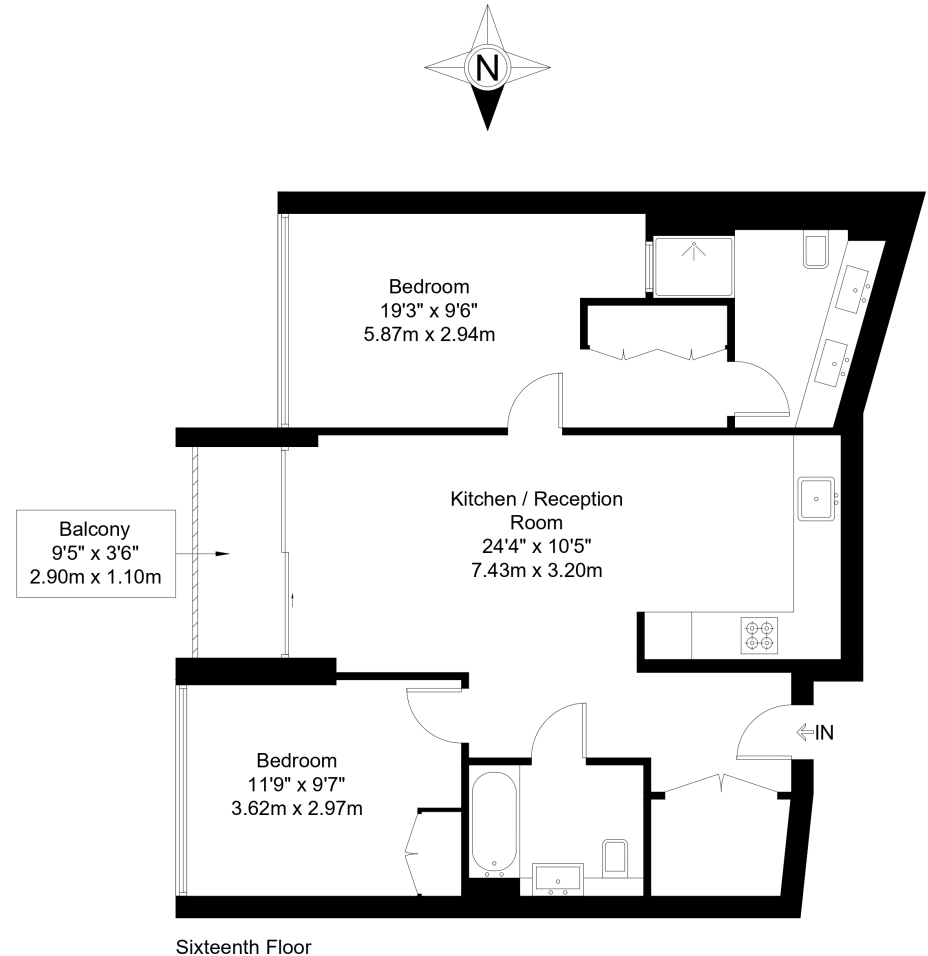

The Floor plan is not to scale and measurements and areas shown are approximate and therefore should be used for illustrative purposes only. The plan has been prepared in accordance with the RICS code of Measuring Practice and whilst we have confidence in the information produced it must not be relied on. Maximum lengths and widths are represented on the floor plan. If there is any aspect of particular importance, you should carry out or commission your own inspection of the property.

Copyright @ BleuPlan

