



1 Pan Peninsula Square, London, E14 9HL

Price:
£ 300,000

1 Pan Peninsula Square, London, E14 9HL

Price: £ 300,000

[View Property](#)

OVERVIEW

Set within the iconic Pan Peninsula development in the heart of Canary Wharf, this exceptional 30th floor studio apartment offers elevated luxury living with panoramic skyline views, world-class resident facilities, and outstanding connectivity across London. Positioned at 1 Pan Peninsula Square, E14, the property presents a rare opportunity for both owner-occupiers and investors seeking a premium London residence within one of the capital's most sought-after dockside destinations.

Beautifully designed with contemporary interiors, floor-to-ceiling glazing and a sophisticated modern finish, the apartment maximises natural light while offering a refined and highly functional living environment. Residents benefit from an exclusive lifestyle experience with access to a 24-hour concierge, fully equipped residents' gym, luxury swimming pool, spa facilities, private cinema, and stylish residents' lounge, creating a five-star living experience in the centre of Canary Wharf.

KEY FEATURES

- 30th floor skyline studio apartment
- Prestigious Pan Peninsula tower residence
- 24-hour concierge and resident security
- Luxury swimming pool and spa
- Fully equipped residents fitness suite
- Private cinema and lounge access
- Moments from Canary Wharf station
- Elizabeth Line and DLR connectivity
- Riverside lifestyle with nearby dining
- Excellent investment and rental appeal

Pan Peninsula Square, E14

Approx Gross Internal Area = 30.7 sq m / 330 sq ft
Balcony = 3.2 sq m / 34 sq ft
Total = 33.9 sq m / 364 sq ft

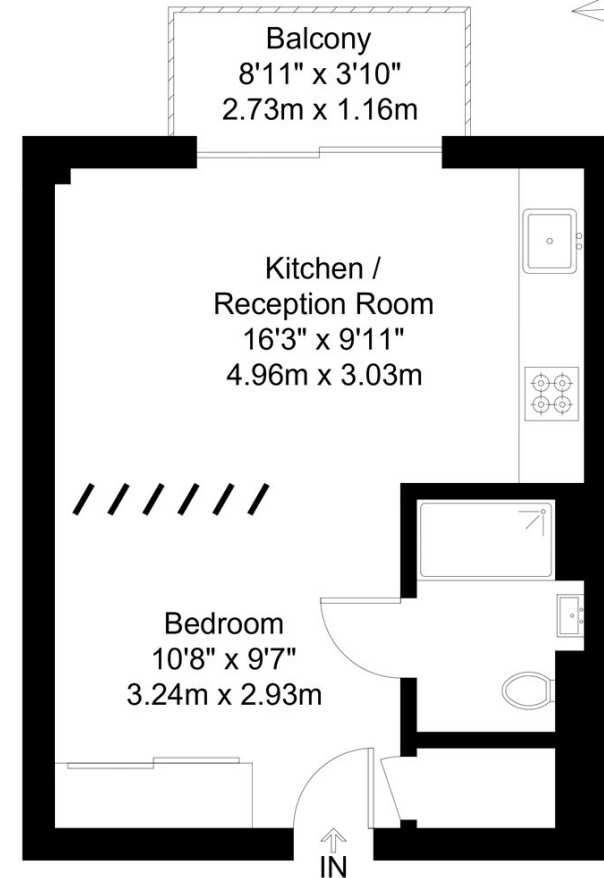

Thirtieth Floor

The Floor plan is not to scale and measurements and areas shown are approximate and therefore should be used for illustrative purposes only. The plan has been prepared in accordance with the RICS code of Measuring Practice and whilst we have confidence in the information produced it must not be relied on. Maximum lengths and widths are represented on the floor plan. If there is any aspect of particular importance, you should carry out or commission your own inspection of the property.
Copyright © BleuPlan

Energy Performance Certificates

