



1 Pan Peninsula Square, London, E14 9HA

Price:

£ 500,000

1 Pan Peninsula Square, London, E14 9HA

Price: £ 500,000 2 bedroom house

[View Property](#)

OVERVIEW

A well-proportioned two-bedroom apartment set on the fifth floor of the highly sought-after Pan Peninsula development, offering approximately 790 sq ft of internal living space and a private balcony.

The apartment comprises a spacious reception room with ample space for both living and dining, leading out to a private balcony providing additional outdoor space. The separate kitchen is fully fitted with integrated appliances and finished to a modern standard.

KEY FEATURES

- Fifth floor apartment within Pan Peninsula
- Two double bedrooms, two bathrooms
- Approx. 790 sq ft of internal space
- Private balcony
- Separate fully fitted kitchen
- 24-hour concierge and residents' facilities
- Gym, pool, cinema and sky lounge
- Excellent transport links via South Quay and Canary Wharf

Pan Peninsula Square, E14

Approx Gross Internal Area = 73.4 sq m / 790 sq ft
Balcony = 3 sq m / 32 sq ft
Total = 76.4 sq m / 822 sq ft

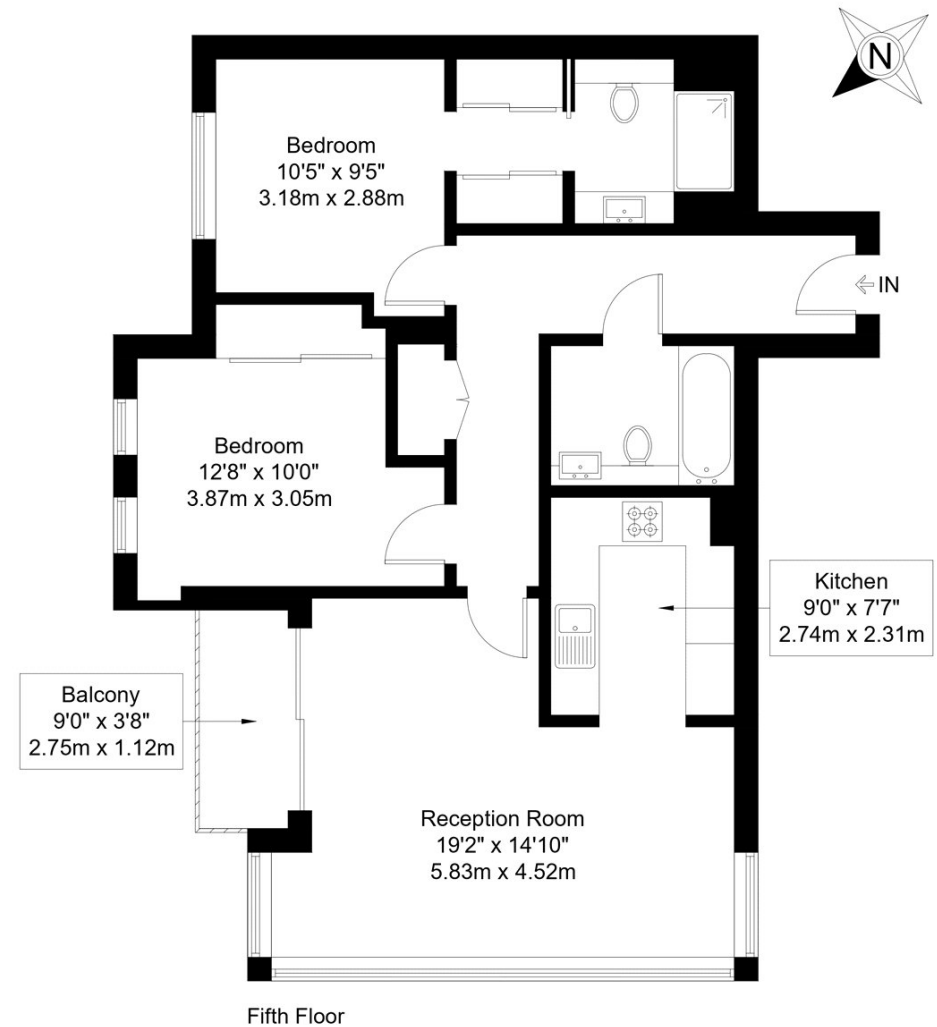

The Floor plan is not to scale and measurements and areas shown are approximate and therefore should be used for illustrative purposes only. The plan has been prepared in accordance with the RICS code of Measuring Practice and whilst we have confidence in the information produced it must not be relied on. Maximum lengths and widths are represented on the floor plan. If there is any aspect of particular importance, you should carry out or commission your own inspection of the property.
Copyright © BleuPlan

Energy Performance Certificates

