



1 Pan Peninsula Square, London, E14 9HA

Price:

£ 500,000

1 Pan Peninsula Square, London, E14 9HA

Price: £ 500,000 2 bedroom house

[View Property](#)

OVERVIEW

A spacious two-bedroom apartment positioned on the fifth floor of the highly regarded Pan Peninsula development, offering approximately 790 sq ft of internal living space and a private balcony.

The apartment comprises a bright reception and dining area with direct access to the balcony, providing an ideal setting for both relaxing and entertaining. Large windows allow for excellent natural light throughout the living space.

KEY FEATURES

- Fifth-floor apartment within the iconic Pan Peninsula development
- Two well-proportioned double bedrooms and two modern bathrooms
- Approximately 790 sq ft of well-designed internal living space
- Private balcony providing valuable outdoor space and natural light
- Separate fully fitted kitchen with integrated appliances and modern finishes
- Residents benefit from a 24-hour concierge service and secure access
- Luxury facilities including gym, swimming pool, cinema, and sky lounge
- Excellent transport links via South Quay DLR and Canary Wharf Station

Pan Peninsula Square, E14

Approx Gross Internal Area = 73.4 sq m / 790 sq ft

Balcony = 3 sq m / 32 sq ft

Total = 76.4 sq m / 822 sq ft

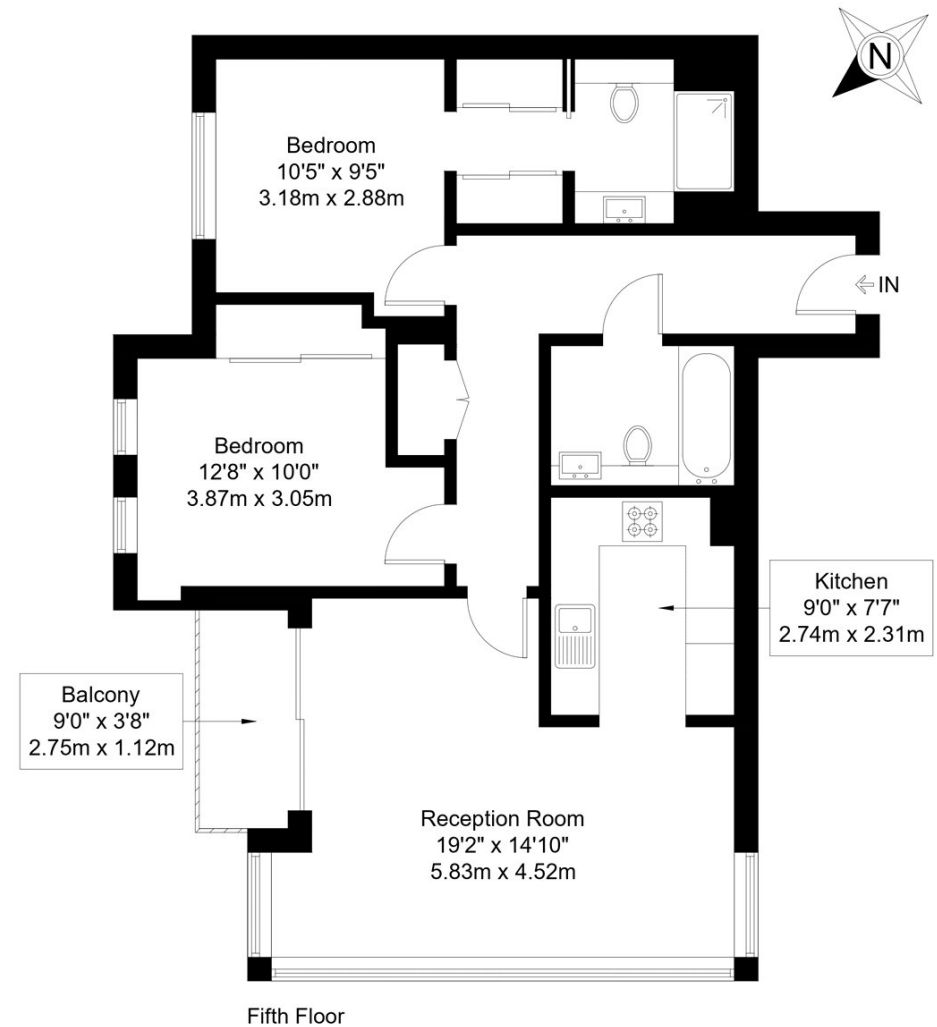

The Floor plan is not to scale and measurements and areas shown are approximate and therefore should be used for illustrative purposes only. The plan has been prepared in accordance with the RICS code of Measuring Practice and whilst we have confidence in the information produced it must not be relied on. Maximum lengths and widths are represented on the floor plan. If there is any aspect of particular importance, you should carry out or commission your own inspection of the property.

Copyright @ BleuPlan

Energy Performance Certificates

